Interpretation System

BXB Electronics



1



Wireless Interpretation System

Introduction

BXB - Interpretation system is designed to provide an open platform for conference systems or devices demanding interpretation. Maximum 16 languages can be handled.

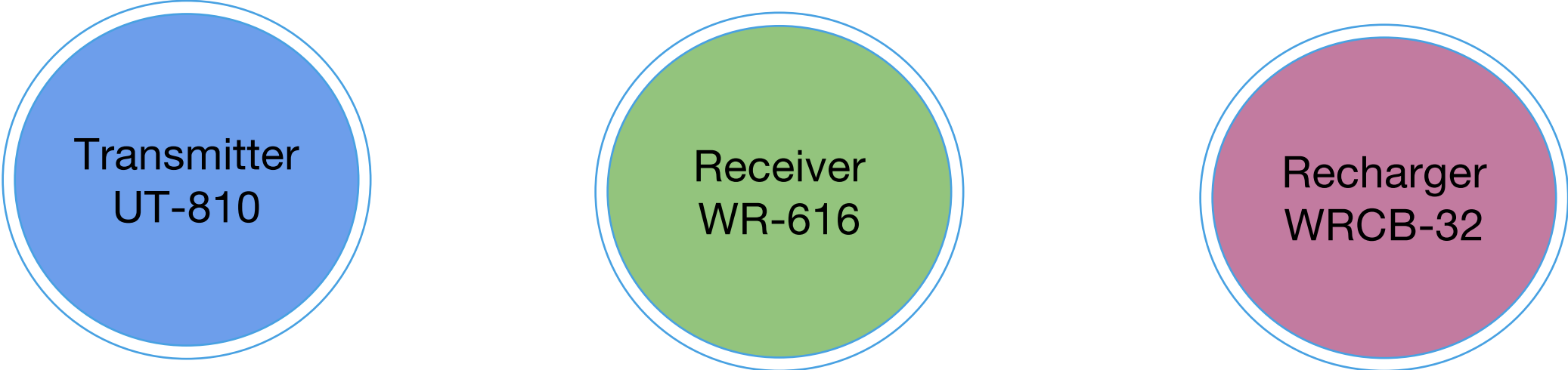

Transmitter
UT-810

Receiver
WR-616

Recharger
WRCB-32



Wired Transmitter UT-810



- UHF PLL synthesized 600-960 MHz
- Single channel transmitter, 16 user selectable channels
- 6.3 XLR input jack, audio RCA input jack
- Audio, Microphone transmitter system
- AF/RF LED display
- Light weight, easy moving, save space
- Operation range: 100-150 meters
- DC-power 12V/500mA
- Matching Receiver: WR-616
- 6.3Ø/3.5Ø EAR monitor-Vol control



Interpreter microphone CTM-01R



- Aluminum shell with smooth appearance
- Skidproof foundation
- Fixed/pluggable gooseneck, uni-directional
43/48/56/70cm microphones with LED
- Frequency range: 100Hz-16KHz
- Sensitivity: $-47 \pm 4\text{dB}$ (0dB=1V/PA,1KHZ)
- S/N ratio: >75dB
- Voltage DC 12V
- Connection: 3pin cable with $\varnothing 6.3\text{mm}$
- Weight: 2.2kg, black color
- Component: 12V/1.5A transformer



Wireless Receiver WR-616



- Frequency range: 600 MHz- 960 MHz
- UHF 16 users selectable channels
- Microprocessor PLL synthesized controlled
- 3.5mm mono earphone out
- Individual wheel to control the volume on receiver
- Battery: AAx2



Recharger Suitcase WRCB-32/40



- 32/40 pieces of wireless receivers using two 1.2V rechargeable batteries
- It is smartly designed for overcharge protection and charge status
- Easy carry, plug, charge with no space limited and no setup required
- To series connection of each charger sets with no number required.
- Power supply: AC: 100-240V \pm 10%, DC:5V(2A-8A)



Connection diagram

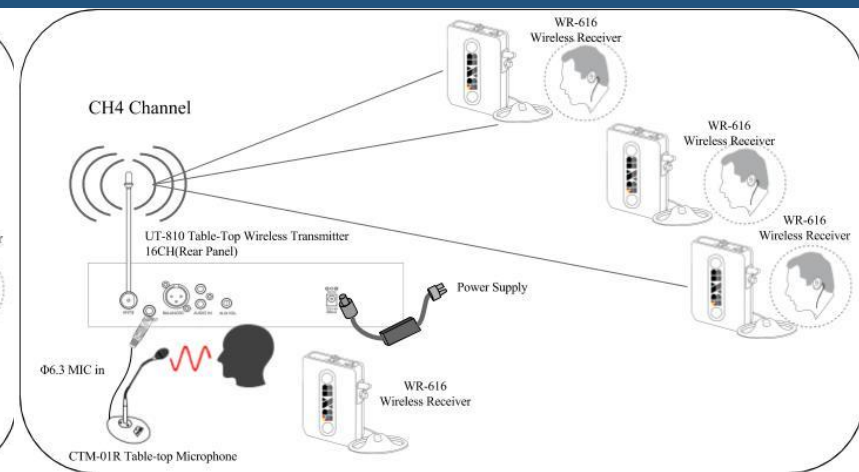
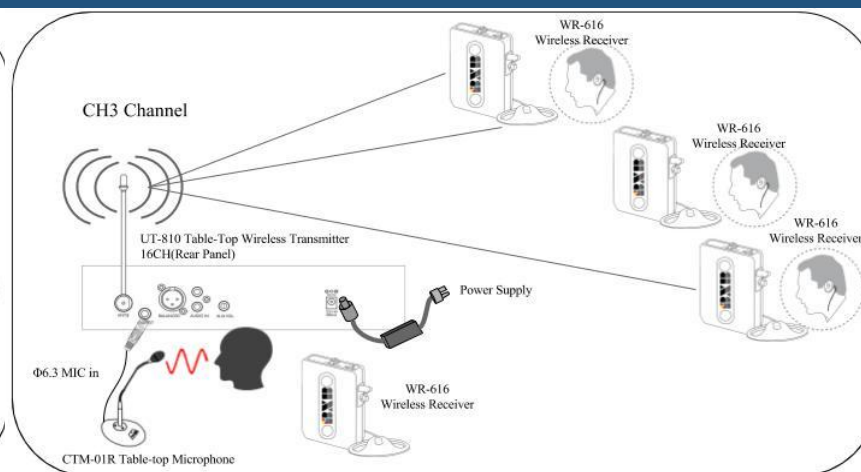
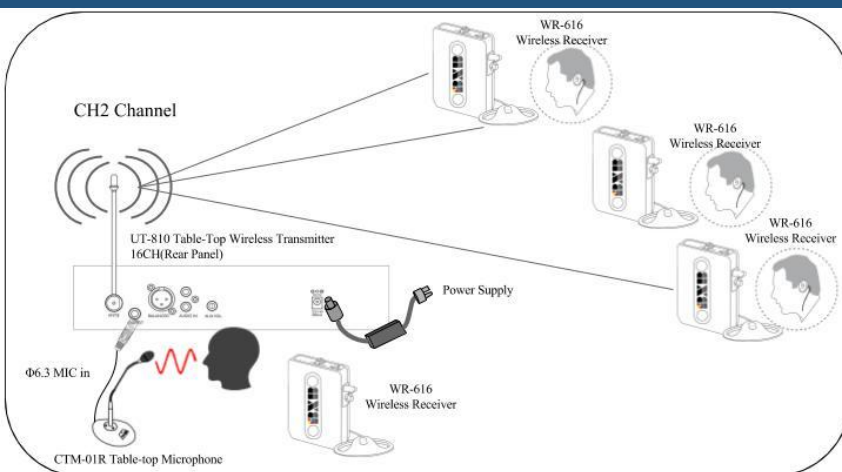
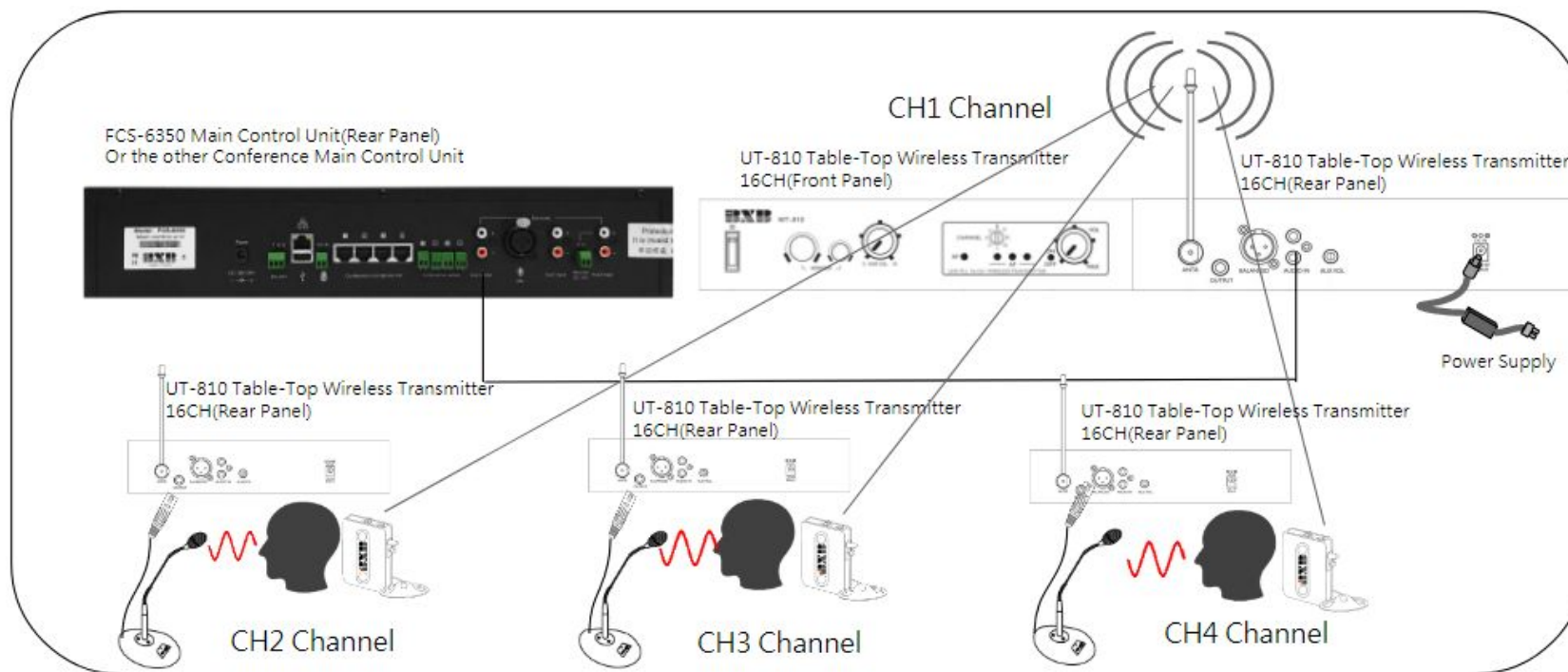



Order example

No	Descriptions	Model	Qty	Unit
1	Wired Transmitter	UT-810	4	pcs
2	Table-top microphone including gooseneck	CTM-01R	3	pcs
3	Wireless receiver	WR-616	103	pcs
4	Charging suitcase	WRCB-32	3	set

Note:

- This quotation example is for 3 languages, 100 receivers.
- Do not forget to add interpreter receiver on the total receivers number.
- Please provide your country frequency, we would be happy to provide our interpretation system.



Installation photo





Installation photo





Installation photo





Installation photo



2



Tour Guide System



Wireless Transmitter WT-616



- Frequency range: 600 MHz- 960 MHz
- UHF 16 users selectable channels
- Microprocessor PLL synthesized controlled
- 3.5mm microphone in
- External antenna for transmitter
- Individual wheel to control the volume on receiver
- Battery: AAx2



Wireless Receiver WR-616



- Frequency range: 600 MHz- 960 MHz
- UHF 16 users selectable channels
- Microprocessor PLL synthesized controlled
- 3.5mm mono earphone out
- Individual wheel to control the volume on receiver
- Battery: AAx2



Recharger Suitcase WRCB-32/40



- 32/40 pieces of wireless receivers using two 1.2V rechargeable batteries
- It is smartly designed for overcharge protection and charge status
- Easy carry, plug, charge with no space limited and no setup required
- To series connection of each charger sets with no number required.
- Power supply: AC: 100-240V \pm 10%, DC:5V(2A-8A)



Order example

No	Descriptions	Model	Qty	Unit
1	Wireless Transmitter	WT-616	1	pcs
2	Wireless receiver	WR-616	30	pcs
3	Charging suitcase	WRCB-32	1	set

Note:

- This quotation example is for 1 tour guide/teacher, 30 tourists/students.
- Please provide your country frequency, we would be happy to provide our interpretation system.



Thank you for your attention!

Website: www.bxb.tw

Twitter: [www.twitter.com@ourbxb](https://twitter.com/ourbxb)

Facebook: <https://www.facebook.com/BXB.tw/>

Linkedin: <https://www.linkedin.com/company/4813342/>