

ClearOne®

CHAT® 70 Personal Speakerphone
Téléphone Personnel
Persönliche Freisprecheinrichtung

Quick Start Guide
Guide de Démarrage Rapide
Anleitung



TABLE OF CONTENTS

CHAT 70 Features	1
Connecting the CHAT 70 to Your Computer	2
Setup	2
Specifications and Requirements	3

CHAT 70 FEATURES

CHAT 70 Caractéristiques

CHAT 70 Funktionen

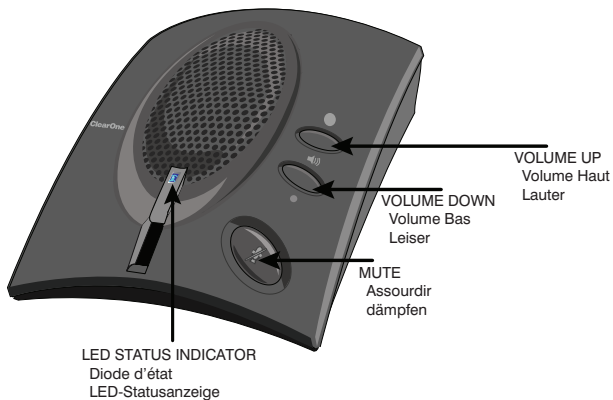

CONNECTING THE CHAT 70 TO YOUR COMPUTER

Connexion de l'CHAT 70 à votre ordinateur
Schließen Sie das CHAT 70 an Ihren Computer an

SETUP

Installation

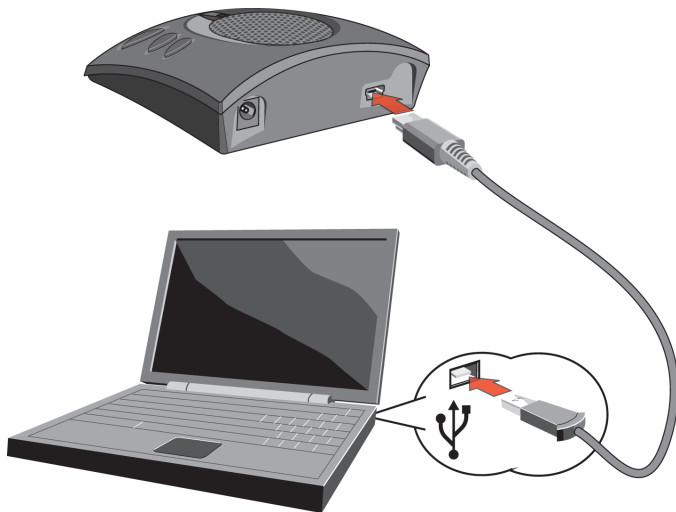

SPECIFICATIONS AND REQUIREMENTS

System Requirements

Windows XP, Vista or 7

Connections

USB:

Version 2.0 Compatible

Type: Mini-B Female

Audio

Speaker

Bandwidth: 220 Hz - 14 kHz

Max Output Level:

80 dB SPL @ 1 foot (0.30 meter)

Microphone

Bandwidth: 50 Hz - 7.75 kHz

Power

USB: 5 VDC @ 500 mA Maximum

External: Input:100-240 VAC, Output:7 VDC
@ 500 mA, Tip: Power, Ring: Ground

Controls

Volume Up

Volume Down

Microphone Mute

Environmental

Operating Temperature:

41 - 104° F (5 - 40° C)

Processing

Full Duplex

Acoustic Echo Cancellation (AEC)

Noise Cancellation (NC)

Automatic Level Control (ALC)

Mechanical

Dimensions (W x D x H):

3.8" x 4.1" x 1.8"

(9.7 cm x 10.4 cm x 4.6 cm)

Weight:

0.55 lbs (0.25 kg)

Compliance

RoHS

REACH

FCC Class B Part 15

ICES-003

UL Listed

CE Listed

Model Numbers

910-159-250 CHAT 70

Using the CHAT 70 with Office Communicator

En Utilisant le CHAT 70 avec Office Communicator
Verwendung von CHAT 70 mit Office Communicator

Software updates and product information for the CHAT 70 are available at:

Mises à jour de logiciels et informations sur les produits pour le CHAT 70 sont disponibles à:

Software-updates und Produktinformationen für das CHAT 70 erhalten Sie unter:

<http://chat70.clearone.com>

Office Communicator 2007 information is available at:

Office Communicator 2007 information est disponible à:

Informationen zum Office communicator 2007 erhalten sie unter:

<http://office.microsoft.com/communicator>