

DS-MBX642L  
DS-MBX647L  
DS-MBX647P



Display size

DS-MBX642L: 40"-42"  
DS-MBX647L: 46"-48"  
DS-MBX647P: 42"-48"



Max load

100lb  
(45.5kg)

**SMARTMOUNT.**

# Digital Menu Board Mount

FOR 40" TO 48" DISPLAYS

Peerless-AV's QSR Menu Board Mount is designed to create a seamless mounting surface through connecting wall plates. Continuous and fixed tilt options allow all displays to be tilted at the same angle with ease, creating a flawless alignment. The kickstand feature holds the bottom of the display away from the wall during cable connection, reducing installation time and cost. Available in landscape and portrait design options, Peerless-AV offers a one-to-one ordering process, making the QSR Menu Board Mount the perfect mounting solution.

*Create a flawless menu board using the continuous and fixed tilt options while reducing your installation time and cost with the kickstand feature.*



## Additional Features

- ✓ Simple one-to-one ordering process
- ✓ Open wall plate reduces wall interference
- ✓ Included security hardware deters tampering and theft
- ✓ Horizontal adjustment provides a seamless appearance
- ✓ DS-MBX642L – landscape configuration for 40"-42" displays with mounting hole patterns 880 x 400mm (34.65"W x 15.75"H)
- ✓ DS-MBX647L – landscape configuration for 46"-48" displays with mounting hole patterns 975 x 400mm (38.40"W x 15.75"H)
- ✓ DS-MBX647P – portrait configuration for 42"-48" displays with mounting hole patterns 550 x 400mm (21.65"W x 15.75"H)

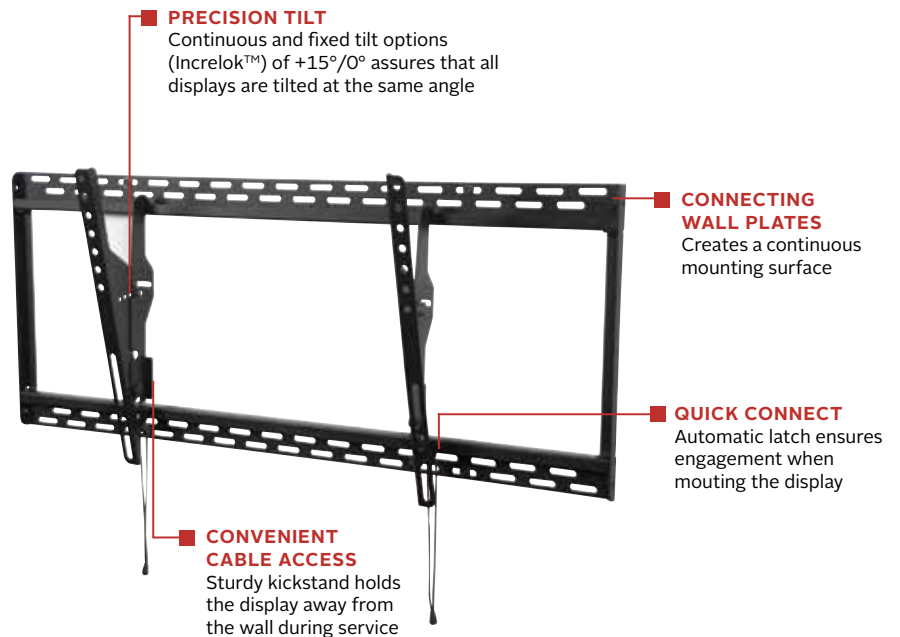

Landscape digital menu board configuration for three displays



8" accessory wall plate for digital menu board configurations



DS-MBX642L	SmartMount® Digital Menu Board Mount for 40"-42" Displays - Landscape
DS-MBX647L	SmartMount® Digital Menu Board Mount for 46"-48" Displays - Landscape
DS-MBX647P	SmartMount® Digital Menu Board Mount for 42"-48" Displays - Portrait

**Product Specifications**

	DIMENSIONS (W x H x D)	PRODUCT WEIGHT	LOAD CAPACITY	FINISH	AVAILABLE COLORS
DS-MBX642L	35.00" x 16.45" x 2.60" (889 x 418 x 66mm)	8lb (3.6kg)			
DS-MBX647L	38.75" x 16.45" x 2.60" (984 x 418 x 66mm)	8.6lb (3.9kg)	100lb (45.5kg)	Matte/Flat	Black
DS-MBX647P	22.00" x 16.45" x 2.60" (559 x 418 x 66mm)	6.6lb (3kg)			

**Package Specifications**

	PACKAGE SIZE (W x H x D)	PACKAGE SHIP WEIGHT	PACKAGE UPC CODE	PACKAGE CONTENTS	UNITS IN PACKAGE
DS-MBX642L	40.25" x 15.50" x 3.50" (1022 x 394 x 89mm)	9.5lb (4.3kg)	735029300960		
DS-MBX647L	40.25" x 15.50" x 3.50" (1022 x 394 x 89mm)	10.5lb (4.8kg)	735029300977	Wall plate, adaptor rails and mounting hardware	1
DS-MBX647P	26.88" x 16.00" x 4.38" (683 x 406 x 111mm)	9lb (4.1kg)	735029300984		

**Accessories**

ACC-MB08: 8" accessory wall plate

All dimensions = inch (mm)

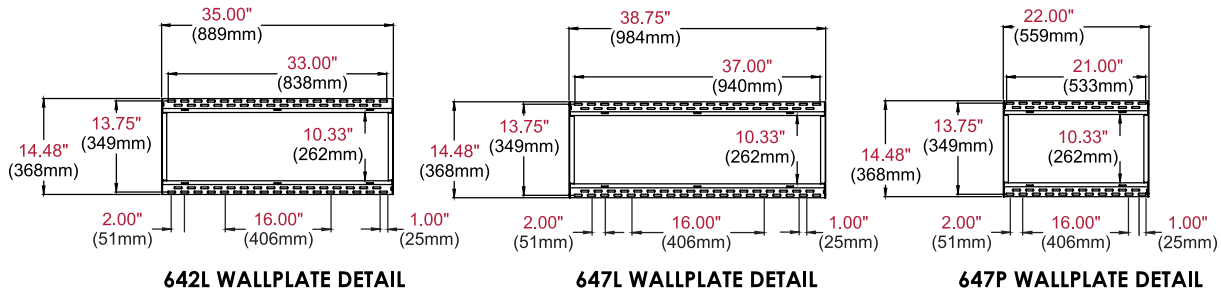

MODEL NO.	DIMENSION "A"	DIMENSION "B"
DS-MBX642L	35.41"(899mm)	34.65"(880mm)
DS-MBX647L	39.16"(995mm)	38.40"(975mm)
DS-MBX647P	22.11"(562mm)	21.65"(550mm)

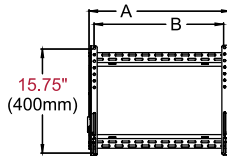

FRONT VIEW

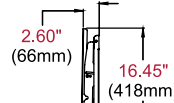

SIDE VIEW HEIGHT

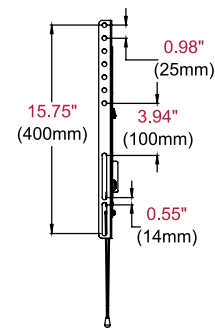

ADAPTOR BRACKET

**Architect Specifications**

The Smartmount® Digital Menu Board Mount shall be a Peerless-AV model DS-MBX642L, DS-MBX647L or DS-MBX647P and shall be located where indicated on the plans. Assembly and installation shall be done according to instructions provided by the manufacturer.

Visit [peerless-av.com](http://peerless-av.com) to see the complete line of AV solutions from Peerless-AV, including outdoor displays, wireless, kiosks, digital audio, display mounts, projector mounts, carts/stands, and a full assortment of accessories.

**Peerless-AV**  
2300 White Oak Circle  
Aurora, IL 60502 USA  
  
**(800) 865-2112**  
**(630) 375-5100**  
**Fax: (800) 359-6500**

**Peerless-AV Europe**  
Unit 3 Watford Interchange  
Colonial Way, Watford  
Herts, WD24 4WP  
United Kingdom  
**+44 (0) 1923 200100**  
**Fax: +44 (0) 1923 200101**

**Peerless-AV de México**  
Ave de las Industrias 413  
Parque Industrial Escobedo  
Escobedo, N.L.,  
Mexico 66050  
**+52 (81) 8384-8300**  
**Fax: +52 (81) 8384-8360**

