

# FCS-6326-43

## Multimedia Conference Lifting Microphone



### Product Features

- ▶ Widely used for paperless meeting, lecture & training rooms, multimedia classrooms, high-end offices, hotels, and more.
- ▶ All-in-one flush-mounted design integrating touch screen and gooseneck microphone, no exposed cable and highly space-saving.
- ▶ The screen and microphone can be lifted individually or concurrently. Via central control system, the microphone can be lifted with single, grouped, or all mode.
- ▶ The gooseneck microphone is equipped with automatic straightening function. When MIC bending, it will be automatically straightening as the machine is off. It won't be damaged.
- ▶ Equipped with HDMI, DVI, VGA, and USB interface for touch screen; plug-and-play.
- ▶ Easily connects with BXB FCS-6350 Conference Main Control Unit to lift / lower the monitor and microphone; available to integrate with environmental control equipment.
- ▶ The screen view angle is adjustable (0-45°), offering the most ideal visual angle to users.
- ▶ Equipped with power saving mode by cutting the electricity off automatically after lifting down, greatly decreasing the power consumption.
- ▶ The gooseneck microphone attached should be BXB WM-43 D1HT / ST model.

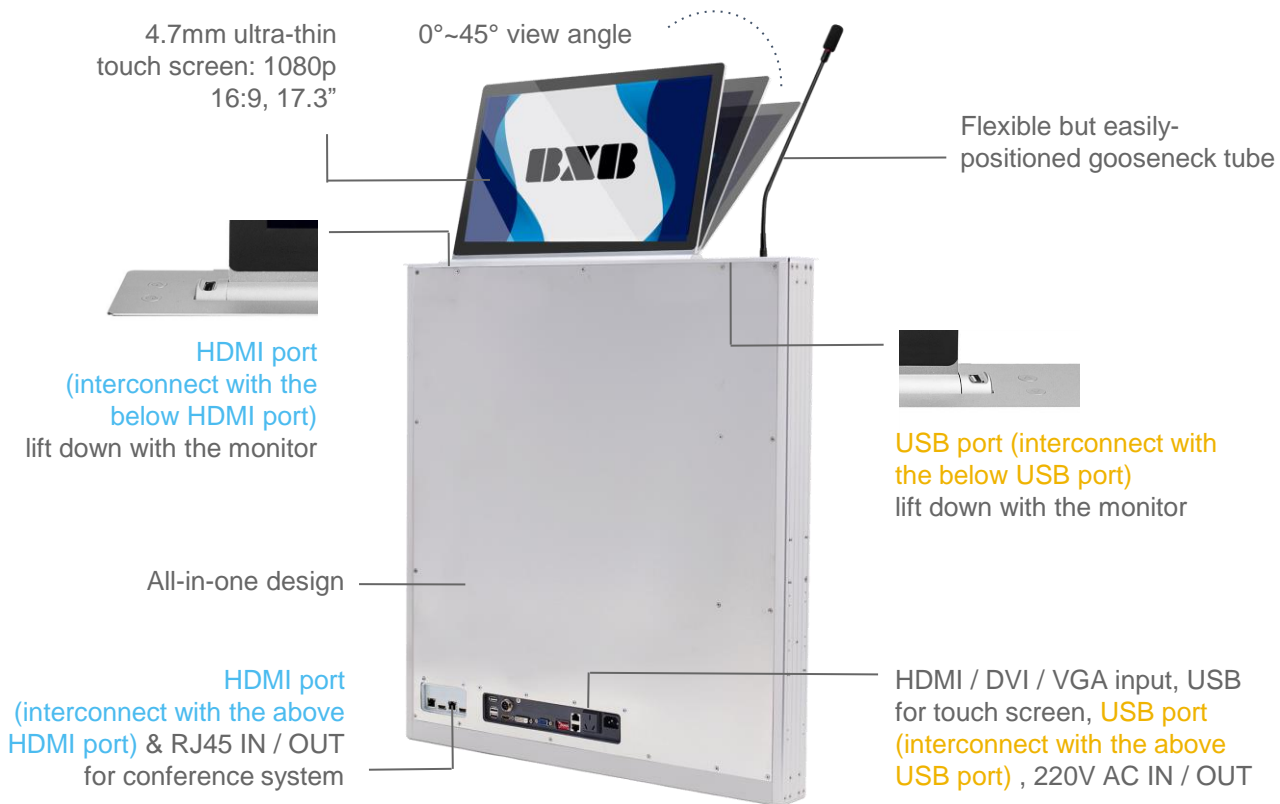

## Hardware Specifications

Screen Inch	17.3"
Screen Ratio	16:9
Resolution	1920*1080
Video Port	VGA/DVI/HDMI
Conference System Port	RJ45 x 2
Touch Screen Port	USB x 1
Video Switch	Control software
Backlight	LED
Contrast Ratio	650:1
Response Time	2/6MS
Brightness	300cb/m2
View Angle	45/45/20/45( L/R/U/D)
Lifting Precision	Horizontal ± 0.2mm Vertical ±0.2 mm
Lifting Angle	0-45°

## Physical Properties

Screen Type	Touch screen
Housing	Aluminum alloy
Screen Size	419x265.7mm
Glass Thickness	≤4.7mm
Load Capacity	≤3.5 Kg
Weight	Net 18.5Kg, Gross 24Kg
Frame Dimension	73 x 650 x 690mm
Panel Dimension	73 x 650mm
Mounting Size	65 x 642mm
Microphone Length	Standard 43cm
Package Size	W720 x D792 x H197mm

## Power Supply

Voltage	AC 220V/1.2A 50HAC
Power Consumption	<100VA