

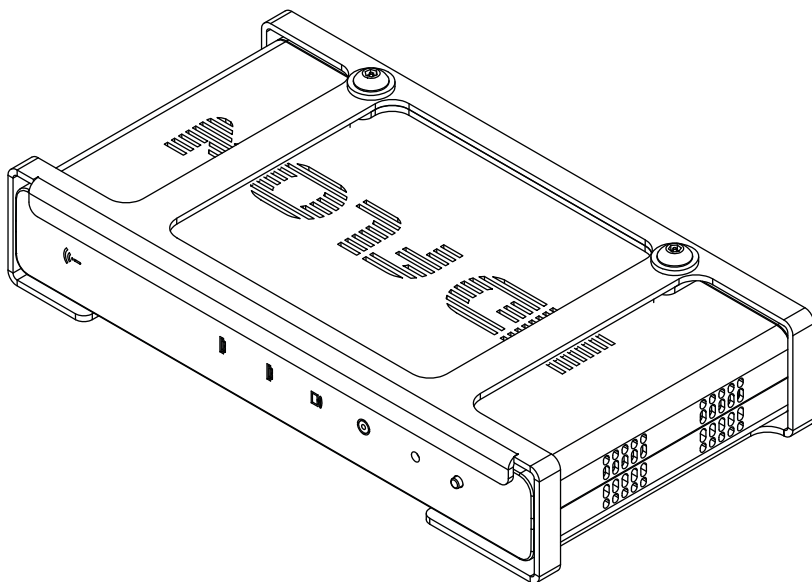

## Installation and Assembly: **HDS200 Security Bracket**

---

**Model:** HDS-ASE



\* Transmitter not included.



**NOTE:** Read entire instruction sheet before you start installation and assembly.

**⚠ WARNING**

- Do not begin to install your Peerless-AV® product until you have read and understood the instructions and warnings contained in this Installation Sheet. If you have any questions regarding any of the instructions or warnings, for US customers please call Peerless-AV® customer care at 1-800-865-2112, for all international customers, please contact your local distributor.
- This product should only be installed by someone of good mechanical aptitude, has experience with basic building construction, and fully understands these instructions.
- Make sure that the supporting surface will safely support the combined load of the equipment and all attached hardware and components.
- If mounting to wood joists, make sure that mounting screws are anchored into the center of the studs. Use of an "edge to edge" stud finder is highly recommended.
- Tighten screws firmly, but do not overtighten. Overtightening can damage the items, greatly reducing their holding power.
- This product is intended for indoor use only. Use of this product outdoors could lead to product failure and personal injury.

**Tools Needed for Assembly**

- stud finder ("edge to edge" stud finder is recommended)
- phillips screwdriver
- drill
- 5/16" bit for solid concrete surface
- 1/8" bit for desk or solid surface
- 5/32" bit for wood stud
- level
- hammer
- Pencil
- Tape Measure

**Table of Contents**

Parts List.....	3
Installation to Single Stud Wall .....	4
Installation to Solid Concrete or Cinder Block.....	5
Desk or Solid Surface .....	6

# Parts List

Description	Qty	
A enclosure assembly	1	180-P1095
B locking flange	1	180-P1062
C #10 x 3/4" wood screw	2	500-9006
D #14 x 1-1/4" wood screw	2	510-9157
E anchor	2	590-0320
F #10 flat washer	2	540-9442
G M5 X 6mm security screw	2	520-1114
H 4mm allen wrench	1	560-9646

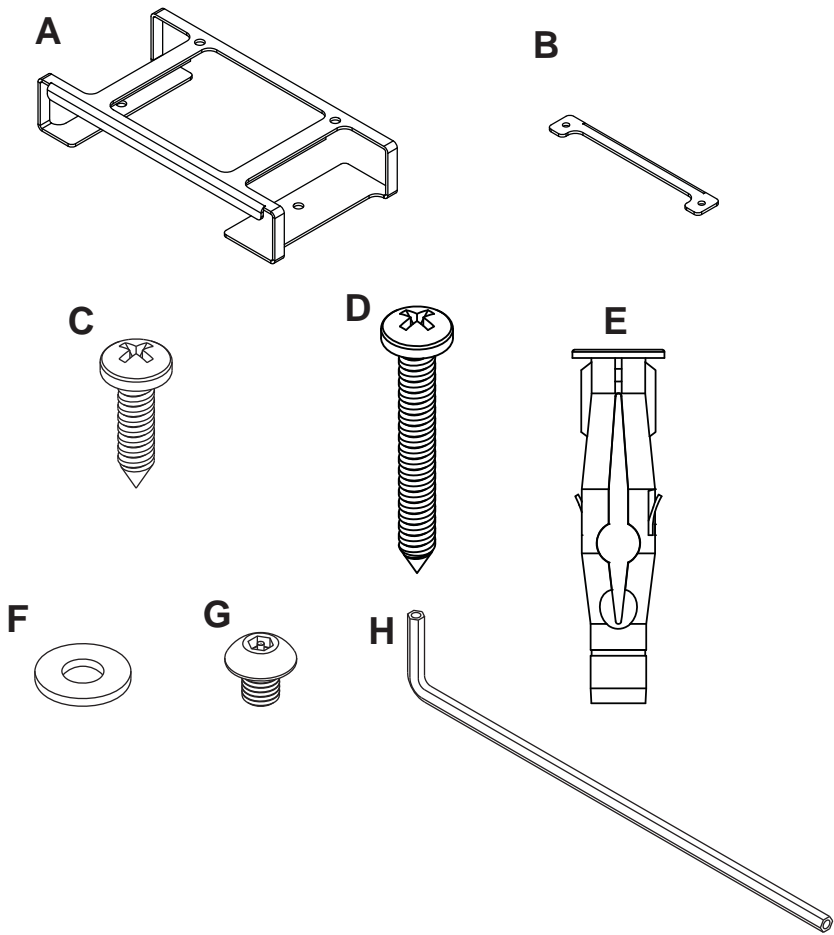

# Installation to Single Stud Wall

## ⚠ WARNING

- Installer must verify that the supporting surface will safely support the combined load of the equipment and all attached hardware and components.
- Tighten wood screws so that wall plate is firmly attached, but do not overtighten. Overtightening can damage the screws, greatly reducing their holding power.
- Never tighten in excess of 80 in. • lb (9 N.M.).
- Make sure that mounting screws are anchored into the center of the stud. The use of an "edge to edge" stud finder is highly recommended.
- Hardware provided is for attachment of mount through standard thickness drywall or plaster into wood studs. Installers are responsible to provide hardware for other types of mounting situations.

- 1** Use a stud finder to locate the edges of the stud and draw a vertical line down the center of the stud. Place security bracket (A) on wall. Level and mark center of two mounting holes as shown in figure 1.1. Drill two 5/32" dia. pilot holes to a depth of 1-1/4". Make sure that security bracket (A) is level and secure it using two wood screws (D) as shown in figure 1.2.

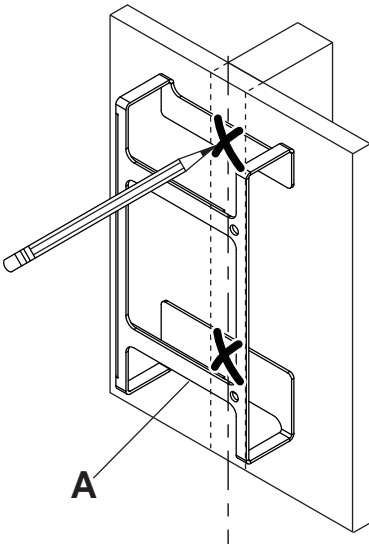

fig. 1.1

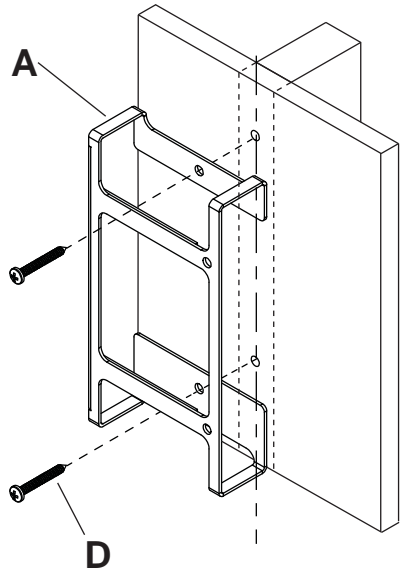

fig. 1.2

# Installation To Solid Concrete or Cinder Block

## ⚠ WARNING

- When installing the security enclosure on cinder block, verify that you have a minimum of 1-3/8" (35 mm) of actual concrete thickness in the hole to be used for the concrete anchors. Do not drill into mortar joints! Be sure to mount in a solid part of the block, generally 1" (25 mm) minimum from the side of the block. Cinder block must meet ASTM C-90 specifications. It is suggested that a standard electric drill on slow setting is used to drill the hole instead of a hammer drill to avoid breaking out the back of the hole when entering a void or cavity.
- Concrete must be 2000 psi density minimum. Lighter density concrete may not hold concrete anchor.
- Installer must verify that the supporting surface will safely support the combined load of the equipment and all attached hardware and components.

- 1** Make sure that security bracket (A) is level and use it as a template to mark two mounting holes. Drill two 5/16" dia. holes to a minimum depth of 2-1/2". Insert anchors (E) in holes flush with wall as shown. Place security bracket (A) over anchors and secure with two wood screws (D).

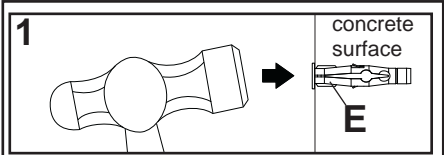

Drill holes and insert anchors (E).

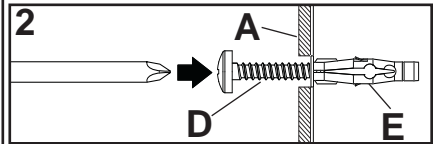

Place security bracket (A) over anchors (E) and secure with screws (D). Tighten all fasteners.

## ⚠ WARNING

- Tighten screws so that the security bracket is firmly attached, but do not overtighten. Overtightening can damage screws, greatly reducing their holding power.
- Never tighten in excess of 80 in. • lb (9 N.M.).
- Always attach concrete expansion anchors directly to load-bearing concrete.
- Never attach concrete expansion anchors to concrete covered with plaster, drywall, or other finishing material. If mounting to concrete surfaces covered with a finishing surface is unavoidable, the finishing surface must be counter bored as shown below. Be sure concrete anchors do not pull away from concrete when tightening screws. If plaster/drywall is thicker than 5/8" (16 mm), custom fasteners must be supplied by installer.

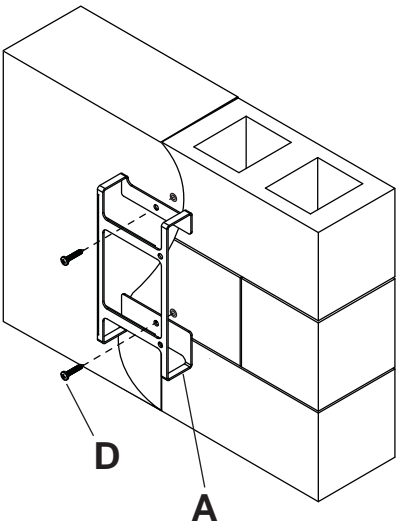
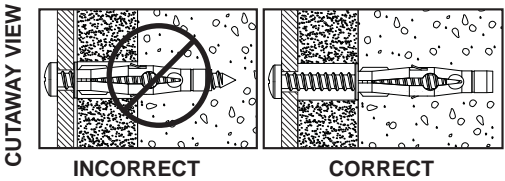

# Installation to Desk or Countertop

**1** **Note:** The thickness of the mounting surface **MUST** be 1" or greater. If mounting to a surface less than 1" thick, shorter mounting screws must be used (not included).

Position security bracket **(A)** on top or underneath a desktop or countertop surface and use it as a template to mark two mounting holes. Drill two 1/8" dia. holes to a maximum depth of 3/4". Secure using two wood screws **(C)**.

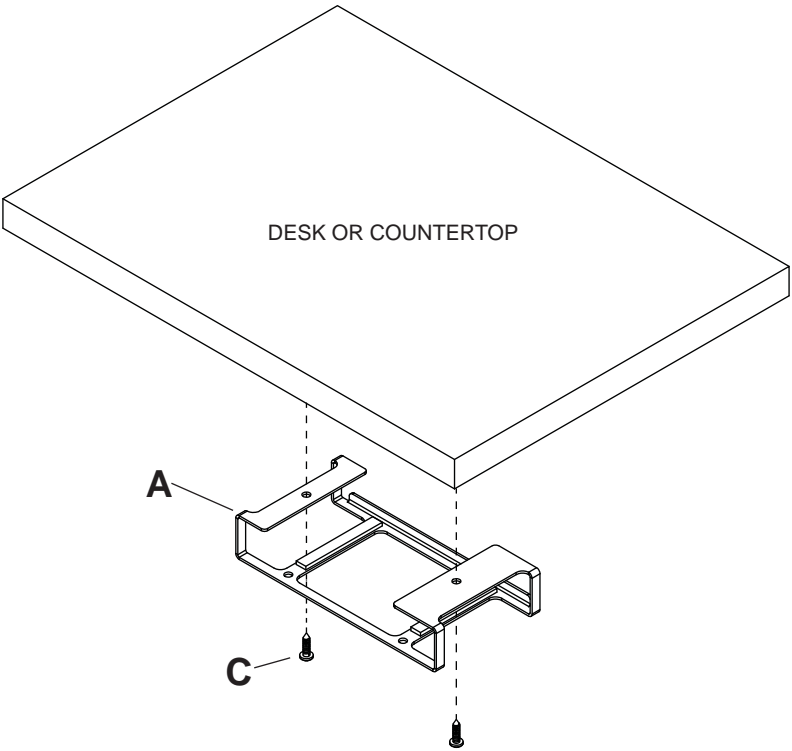

- 2** Install the HDS200 Transmitter (not included) into security bracket (**A**). Position the retainer (**B**) into the bracket so that the holes in retainer (**B**) line up with the holes in the security bracket (**A**).

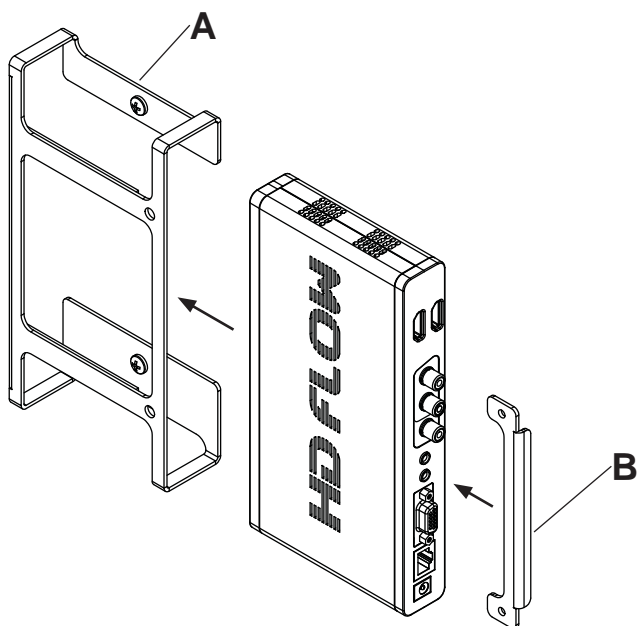

- 3** Secure retainer (**B**) using two M5 X 6mm screws (**G**) and two washers (**F**). Tighten screws using 4mm allen wrench (**H**) provided.

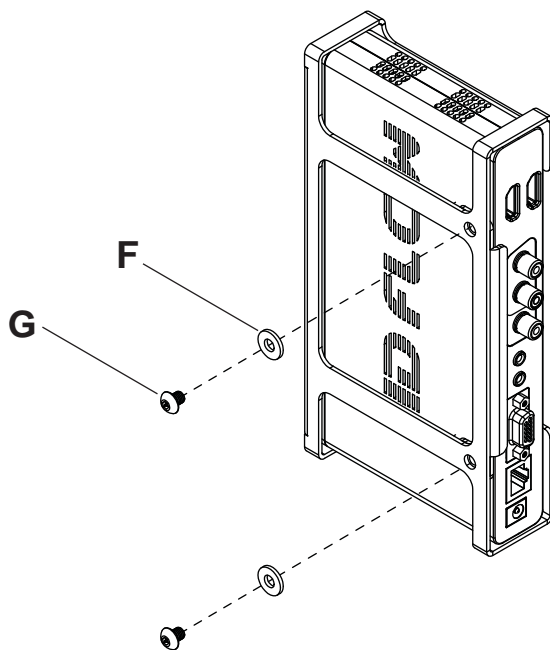



## LIMITED WARRANTY

Peerless Industries, Inc. ("Peerless-AV<sup>®</sup>") warrants to original end-users of Peerless-AV<sup>®</sup> products that Peerless-AV<sup>®</sup> products will be free from defects in material and workmanship, under normal use, for the periods listed below, from the date of purchase by the original end-user. At its option, Peerless-AV<sup>®</sup> will repair or replace with new or refurbished products or parts, or refund the purchase price of any Peerless-AV<sup>®</sup> product which fails to conform with this warranty.

**In no event shall the duration of any implied warranty of merchantability or fitness for a particular purpose be longer than the period of the applicable express warranty set forth above.** Some states do not allow limitations on how long an implied warranty lasts, so the above limitation may not apply to you.

This warranty does not cover damage caused by (a) service or repairs by the customer or a person who is not authorized for such service or repairs by Peerless-AV<sup>®</sup>, (b) the failure to utilize proper packing when returning the product, (c) incorrect installation or the failure to follow Peerless-AV<sup>®</sup>'s instructions or warnings when installing, using or storing the product, or (d) misuse or accident, in transit or otherwise, including in cases of third-party actions and force majeure. This warranty also does not cover corrosion or rust resulting from damaged, scratched or chipped paint or other surfaces.

**In no event shall Peerless-AV<sup>®</sup> be liable for incidental or consequential damages or damages arising from the theft of any product, whether or not secured by a security device which may be included with the Peerless-AV<sup>®</sup> product.** Some states do not allow the exclusion or limitation of incidental or consequential damages, so the above limitation or exclusion may not apply to you.

This warranty is in lieu of all other warranties, express or implied, and is the sole remedy with respect to product defects. No dealer, distributor, installer or other person is authorized to modify or extend this Limited Warranty or impose any obligation on Peerless-AV<sup>®</sup> in connection with the sale of any Peerless-AV<sup>®</sup> product.

This warranty gives specific legal rights, and you may also have other rights which vary from state to state.

<u>Product</u>	<u>Warranty Period</u>
Mounts	5 years
Furniture	1 year
Cables	25 years
Cleaning Products	1 year
Electronic Products and components	1 year

## Notes

---

## Notes

---



**Peerless-AV**  
2300 White Oak Circle  
Aurora, IL 60502  
Email: [tech@peerlessmounts.com](mailto:tech@peerlessmounts.com)  
Ph: (800) 865-2112  
Fax: (800) 359-6500  
[www.peerless-av.com](http://www.peerless-av.com)

© 2013, Peerless Industries, Inc.