

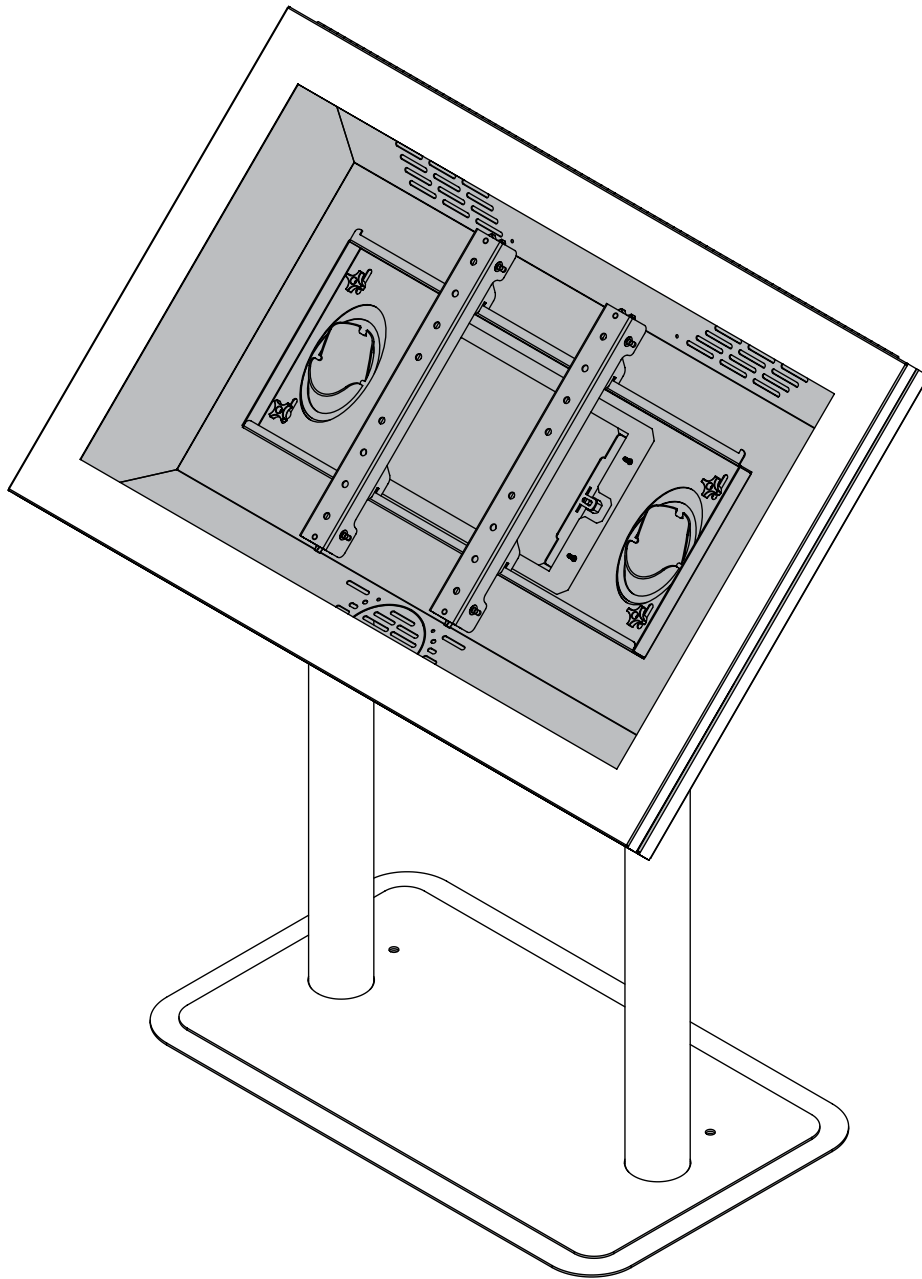

Installation and Assembly: Indoor Digital Signage/Kiosk Enclosure - Landscape

Model: KL540-S, KL546-S, KL540-AB, KL546-AB, KL540-AW, KL546-AW



Maximum Load Capacity:
75 lb (28 kg)

PARTS LIST		KL540-S	KL546-S	KL540-AB	KL546-AB	KL540-AW	KL546-AW
Description	Qty.	Part #	Part #	Part #	Part #	Part #	Part #
A stand weldment	1	145-F4596	145-F4596	145-S1596	145-S1596	145-S2596	145-S2596
B base weldment	1	145-F4553	145-F4553	145-S1553	145-S1553	145-S2553	145-S2553
C enclosure assembly	1	145-F4600	145-F4599	145-S1600	145-S1599	145-S2600	145-S2599
D adapter plate	1	145-F4579	145-F4579	145-S1579	145-S1579	145-S2579	145-S2579
E adapter bracket	2	145-F4597	145-F4597	145-S1597	145-S1597	145-S2597	145-S2597
F 1/4-20 knob	4	560-1199	560-1199	560-1199	560-1199	560-1199	560-1199
G #8-32 socket cap screw	8	520-1210	520-1210	520-1210	520-1210	520-1210	520-1210
H rubber foot	8	590-1288	590-1288	590-1288	590-1288	590-1288	590-1288
I 1/4-20 flanged locknut	2	530-2021	530-2021	530-2021	530-2021	530-2021	530-2021
J nylon shoulder washer	4	590-2233	590-2233	590-2233	590-2233	590-2233	590-2233
K M6 x 12 mm socket pin screw	4	520-1050	520-1050	520-1050	520-1050	520-1050	520-1050
L M8 x 15 mm socket pin screw	4	520-1068	520-1068	520-1068	520-1068	520-1068	520-1068
M 4 mm allen wrench	1	560-9646	560-9646	560-9646	560-9646	560-9646	560-9646
N hinged door	1	145-F4598	145-F4598	145-S1598	145-S1598	145-S2598	145-S2598
O 9/64" allen wrench	1	560-9728	560-9728	560-9728	560-9728	560-9728	560-9728
P 1/4-20 x 1/2" socket pin screw	4	520-2069	520-2069	520-1054	520-1054	520-2069	520-2069
Q M4 nylock nut	2	530-9415	530-9415	530-9415	530-9415	530-9415	530-9415
R lock key (not shown)	3	565-0052A	565-0052A	565-0052A	565-0052A	565-0052A	565-0052A
S M8 x 20 socket pin screw	4	520-1120	520-1120	520-1120	520-1120	520-1120	520-1120

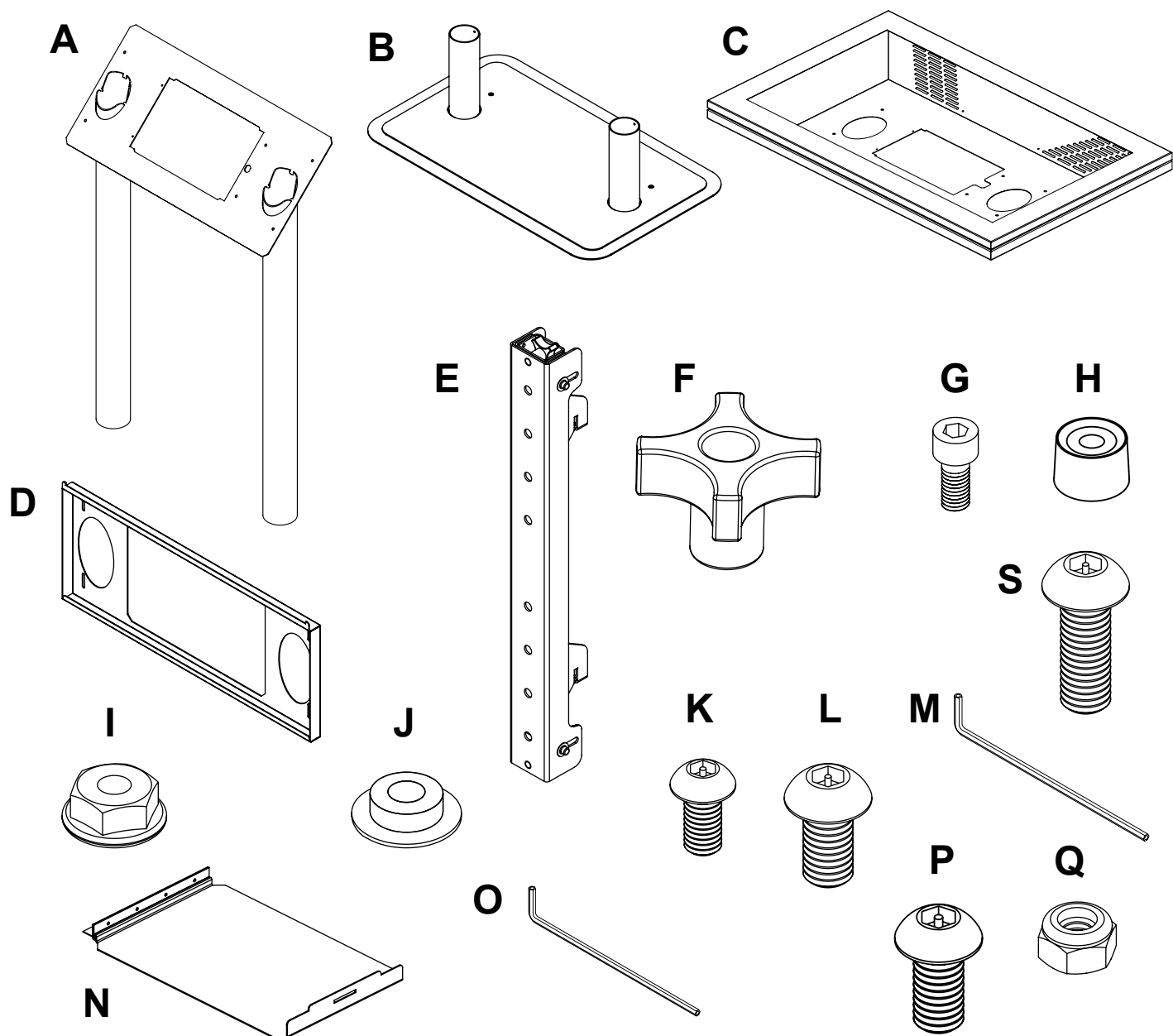

- 1** Tip base weldment (B) backward onto floor. Secure eight rubber feet (H) using eight #8-32 x 3/8" socket head cap screws (G) to bottom of base weldment (B) using tool (O) as shown below.
NOTE: Do not over tighten.

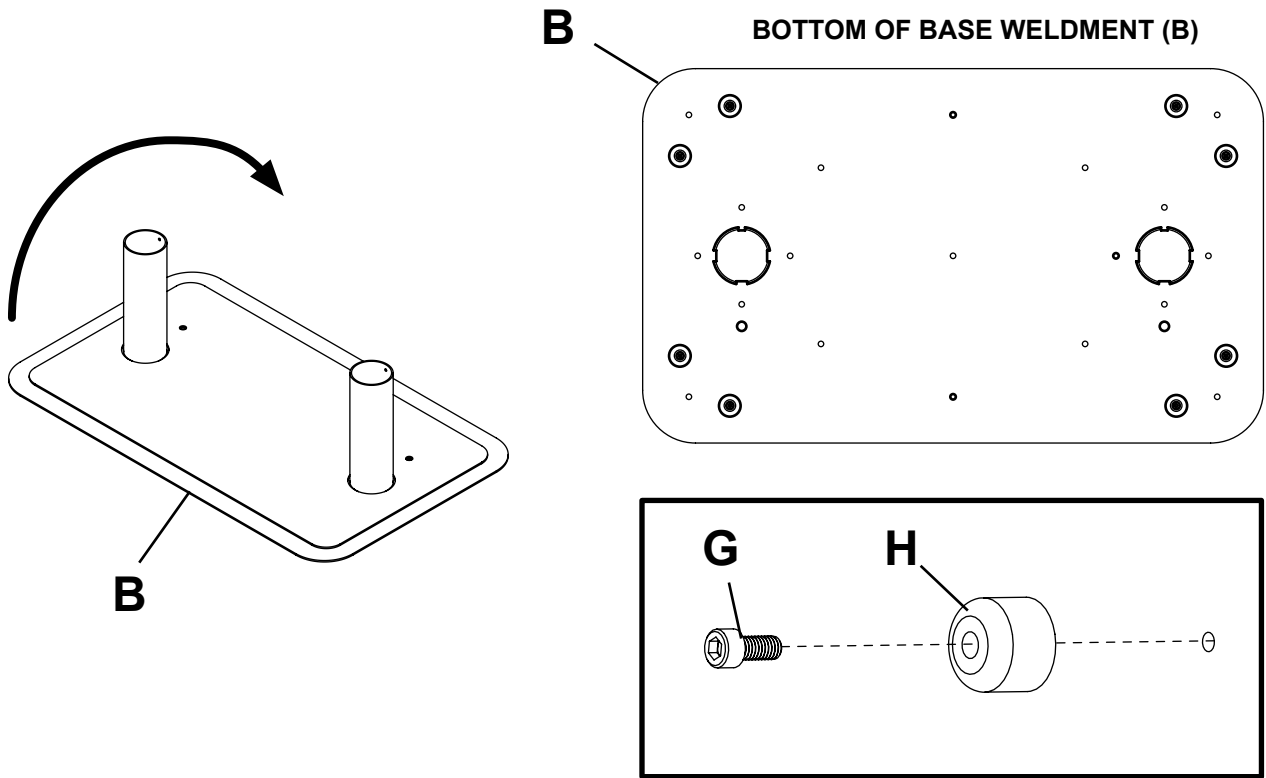

- 2** Attach stand weldment (A) to base weldment (B) using four 1/4-20 socket pin screws (P).
NOTE: Loosely fasten all 1/4-20 socket pin screws (P), then tighten all screws using 4 mm allen wrench (M) until stand weldment is secure.

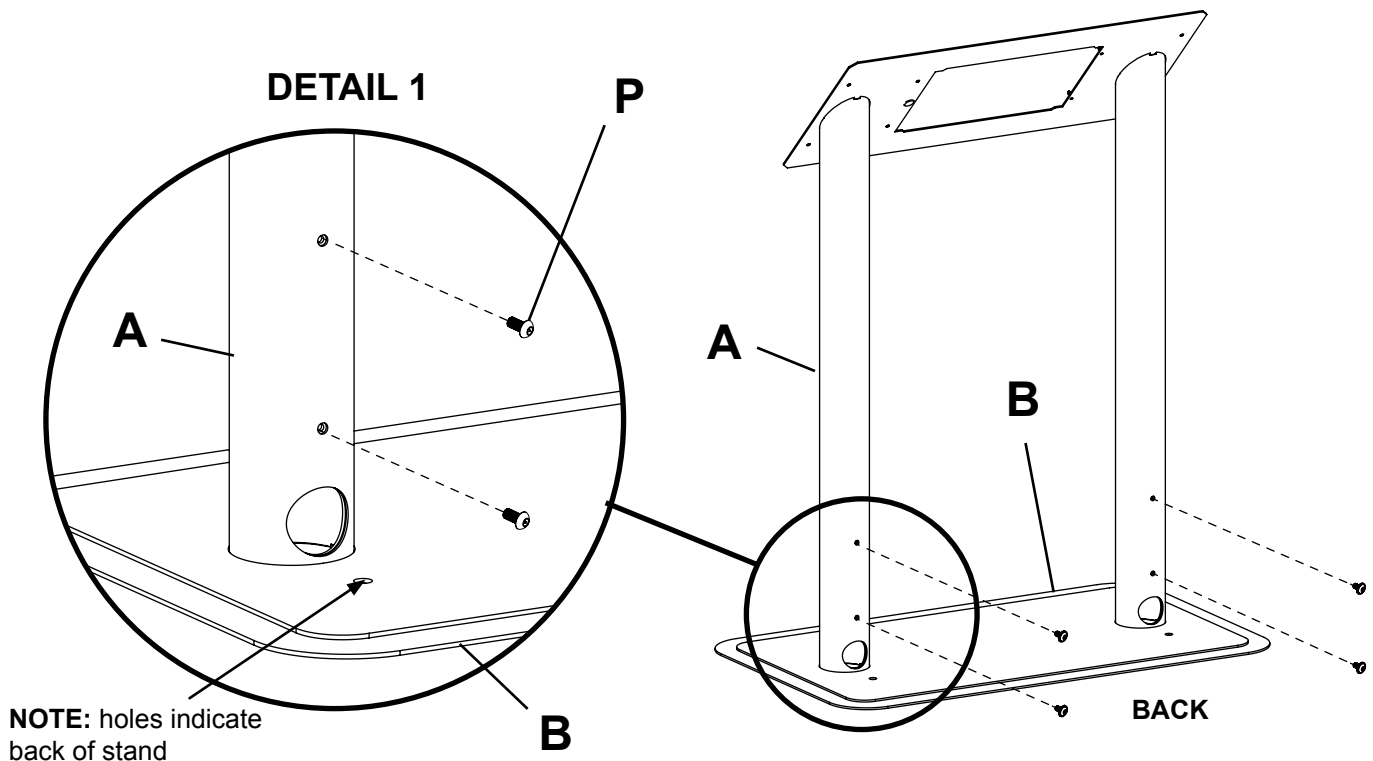

- 3** Position enclosure assembly (C), and adapter plate (D) on top of stand weldment (A). Make sure that holes in enclosure assembly (C), and adapter plate (D) go over threaded studs in stand weldment (A)

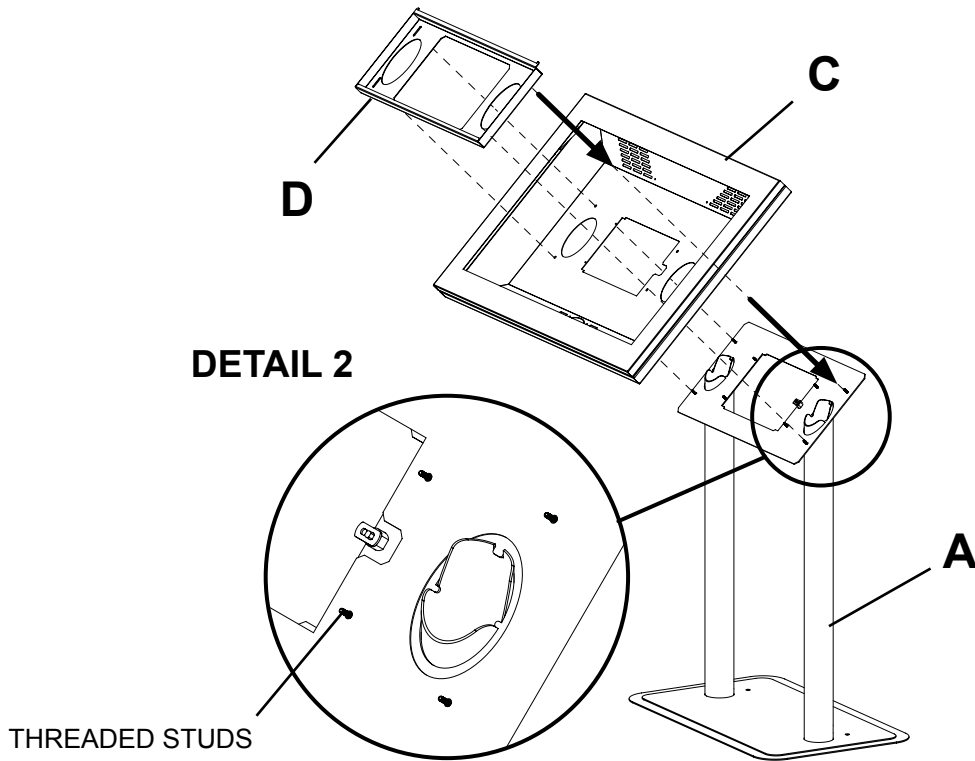

- 3** Secure enclosure assembly (C) using two 1/4-20 flanged locknuts (I) as shown in detail 3.

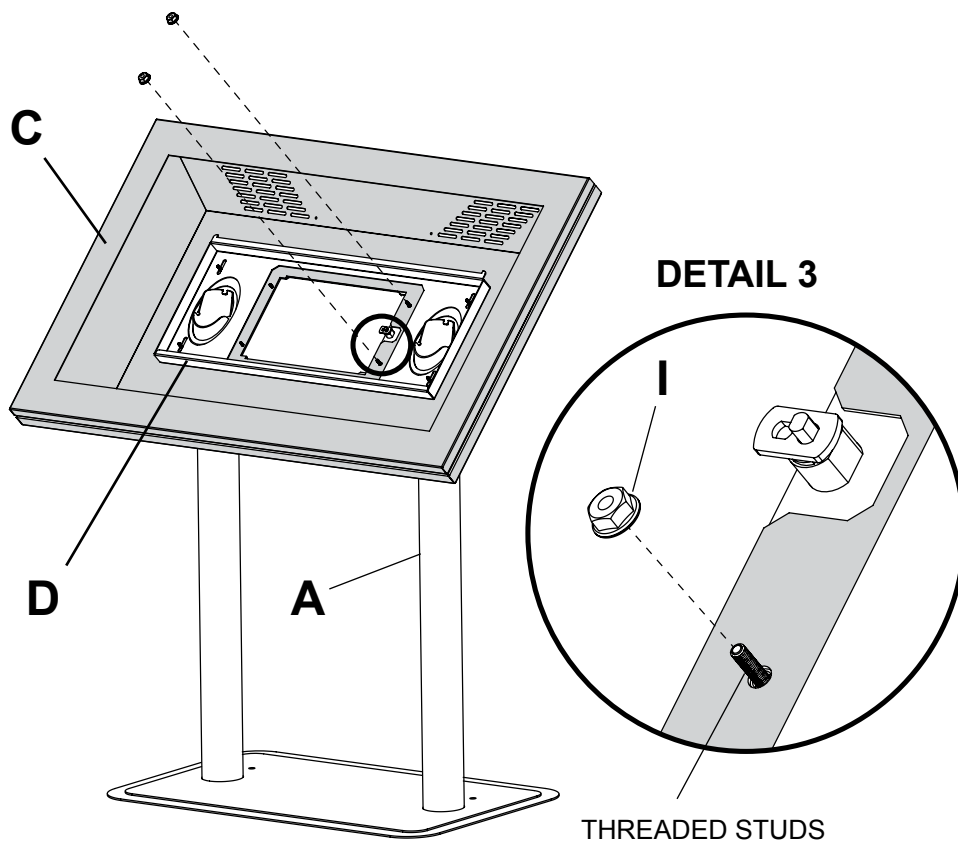

- 3** Secure adapter plate (D) to enclosure assembly (C) using four 1/4-20 knobs (F) as shown in detail 4. Adapter plate (D) can be adjusted vertically by loosening 1/4-20 knobs (F) as shown in detail 4.

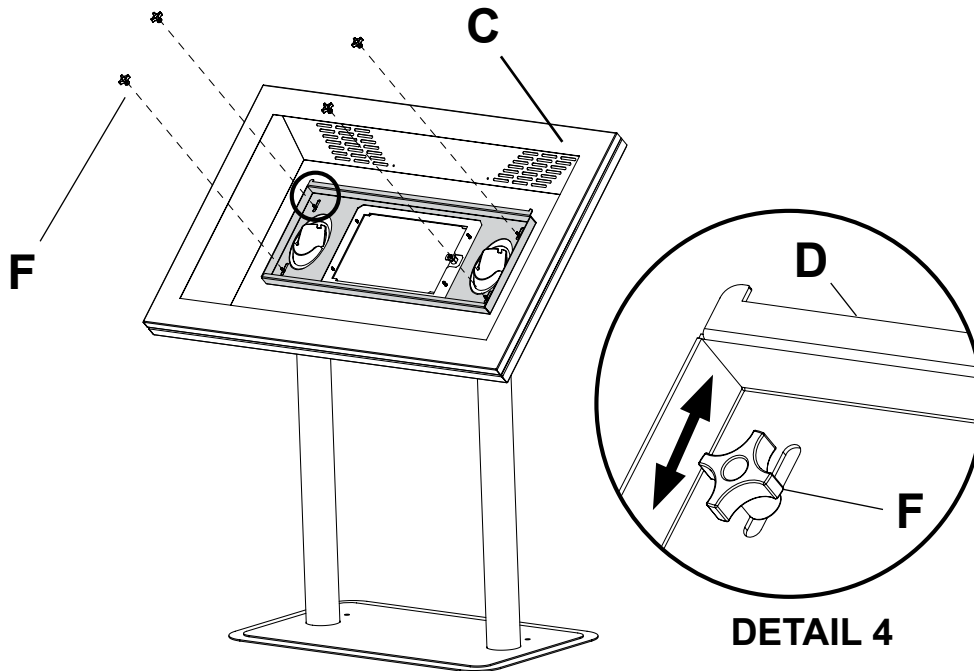

Attaching Hinged Door on back of Stand Weldment

- 4** **NOTE:** Make sure that lock is opened and positioned as shown in detail 5. Position hinged door (N) inside door opening as shown in detail 5.

Position hinge on top of two threaded studs in stand weldment (A) as shown in detail 6. Once hinged door (N) is in place, fasten two M4 nylock nuts (Q) as shown in detail 6. Close lock.

DETAIL 5

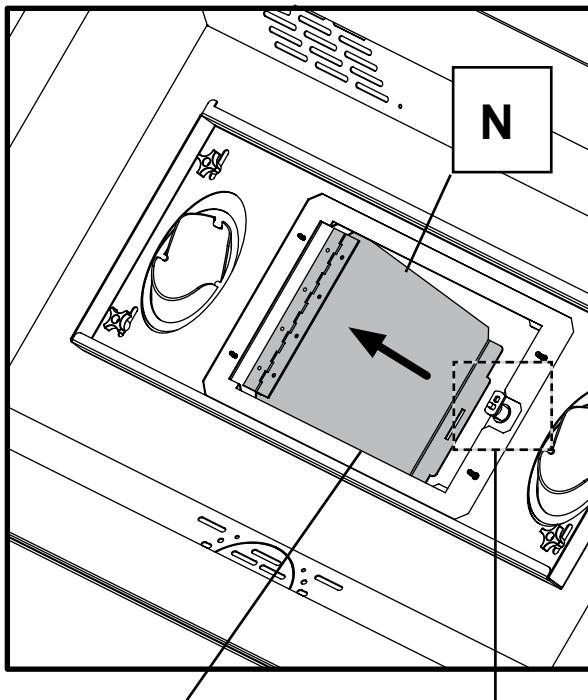

DOOR OPENING

NOTE: MAKE SURE THAT LOCK IS POSITIONED AS SHOWN

DETAIL 6

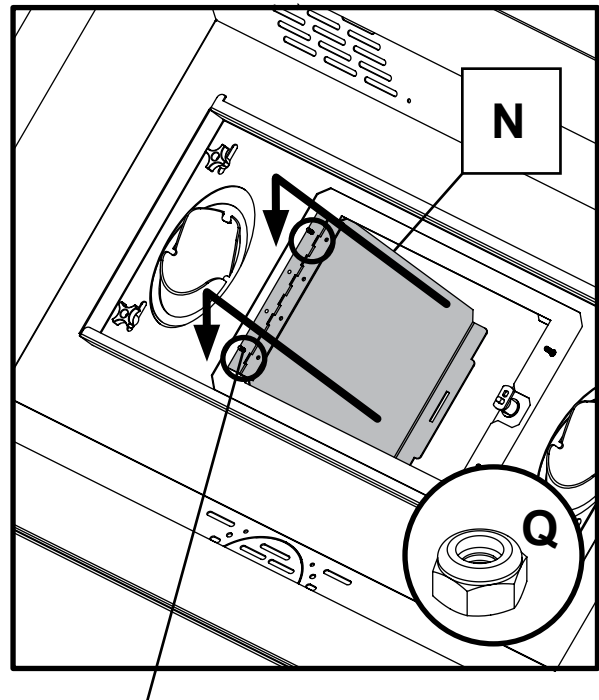

DOOR THREADED STUDS

Attaching Adapter Brackets to Display

- 5** Attach adapter brackets (**B**) to back of display using four M6 x 12 mm socket pin screws (**K**) with nylon shoulder washer (**J**), or four M8 x 15 mm socket pin screws (**L**), or M8 x 20 mm socket pin screws (**S**) as shown in detail 6.

NOTE: Some displays may have offset hole patterns. When using offset hole patterns make sure that adapter brackets (**B**) are centered on back of display.

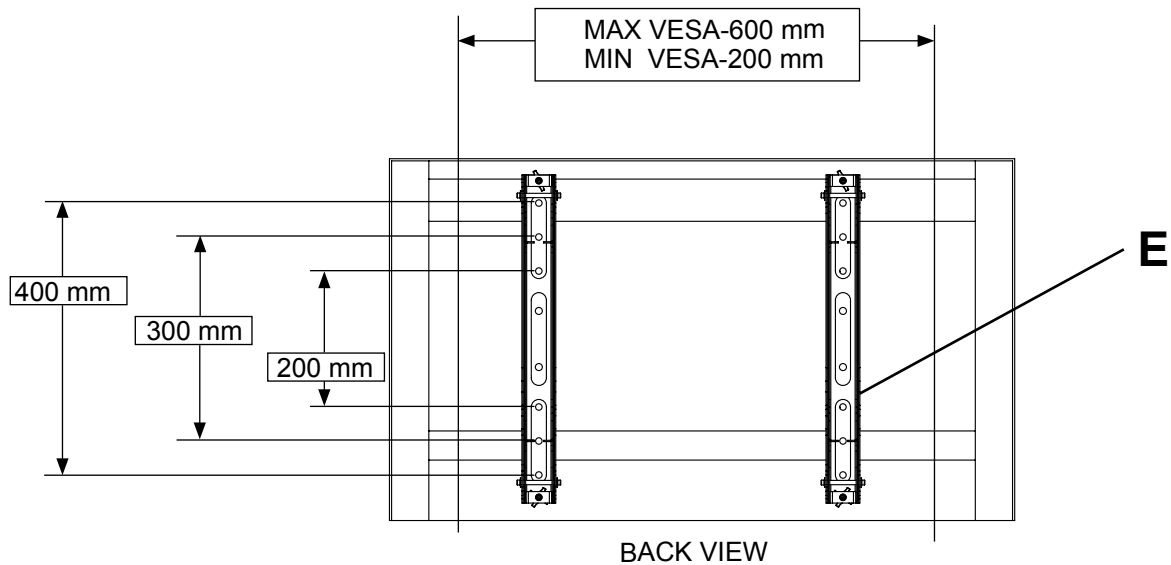

Attach adapter brackets (**E**) and display onto channels on adapter plate (**D**) as shown in detail 7.

Adapter Brackets (**E**) and display can be adjusted horizontally.

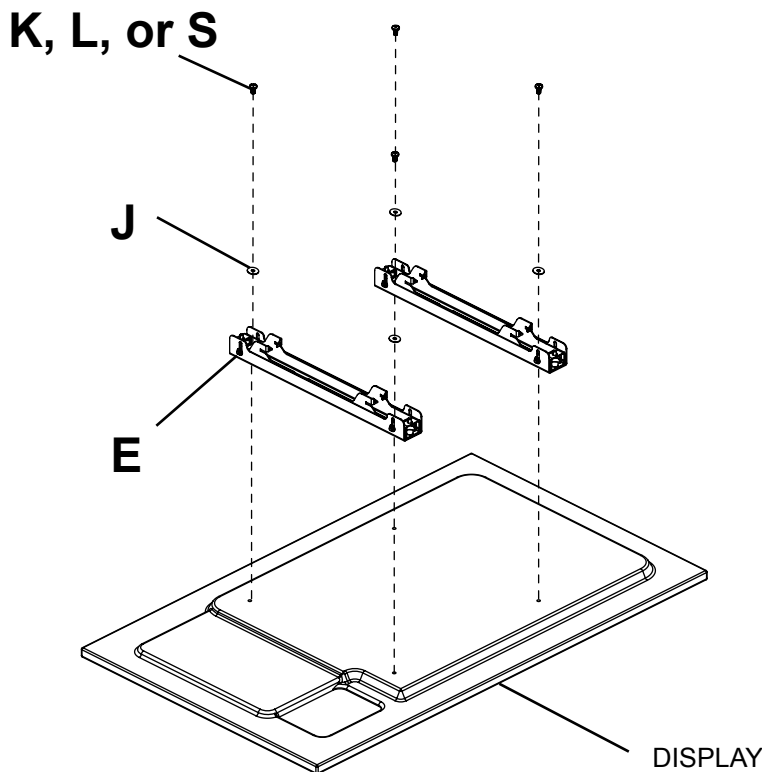

DETAIL 6

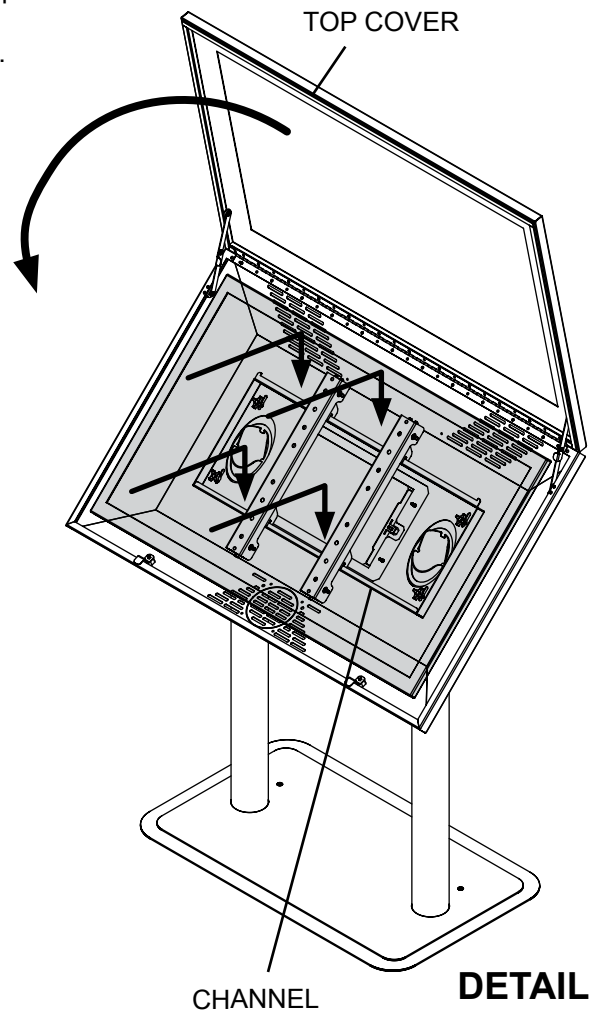

DETAIL 7

Adapter Assembly Adjustment

- 6** Use legend below to determine position of display.
NOTE: Each knob can be adjusted independently for fine tuning adjustments.

 Turn knob **CLOCKWISE** to tighten

 Turn knob **COUNTER-CLOCKWISE** to loosen

IN

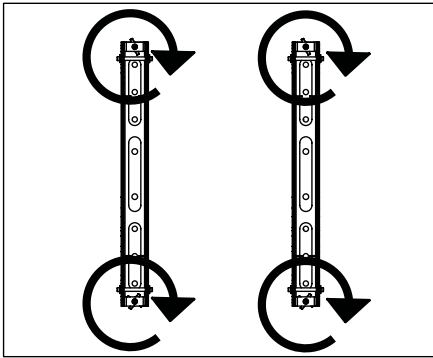

OUT

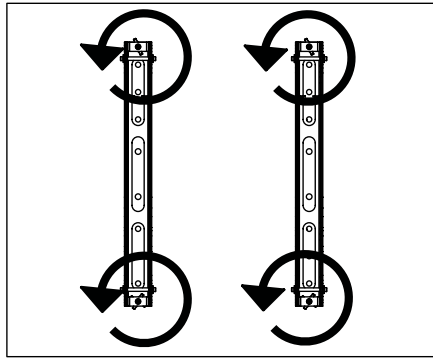

TILT FORWARD

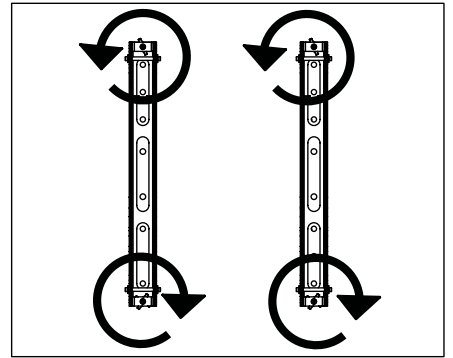

TILT BACKWARD

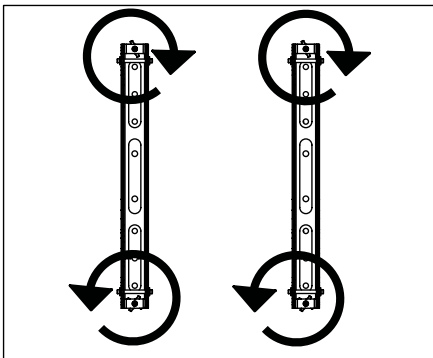

TILT RIGHT

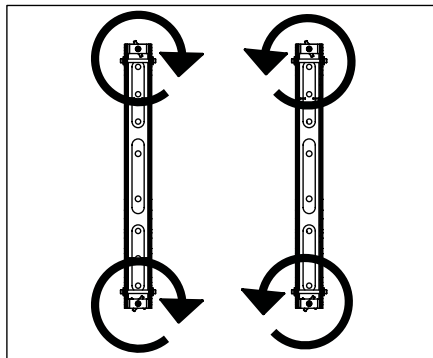

TILT LEFT

