



MK 8

- Quick Guide
 - Kurzanleitung
 - Guide de démarrage rapide
 - Guía rápida
 - Instrucciones resumidas
 - Instruções resumidas
 - Beknopte gebruiksaanwijzing
 - Krótká instrukcja obsługi
 - Snabbguide
- Kort vejledning
 - Pikaohje
 - Σύντομες οδηγίες
 - Kisa Kilavuz
 - Краткая инструкция
 - 快速指南
 - 快速使用指南
 - クイックガイド
 - 요약 안내서

SENNHEISER

In the box

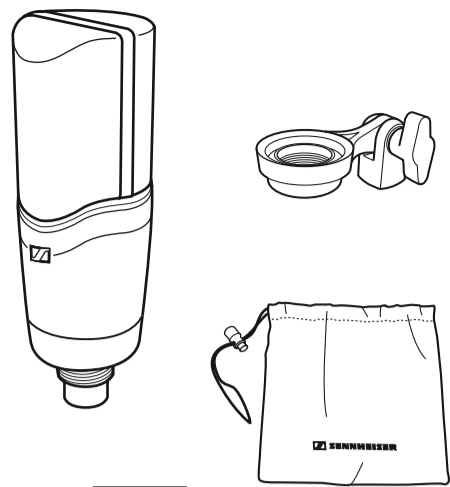

Overview

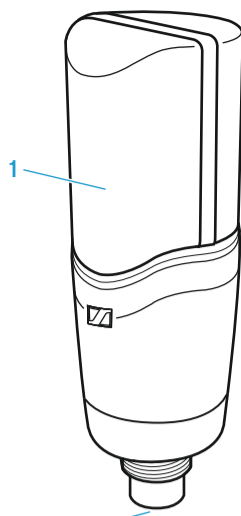

Adjusting

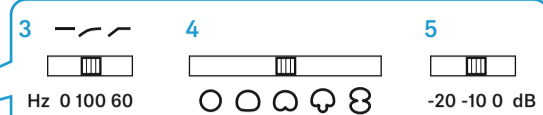

- 1 Sound inlet basket
- 2 XLR-3 connector
- 3 switch for low-cut/roll-off filter
- 4 switch for adjusting the pick-up pattern
- 5 switch for attenuation

Setup

1

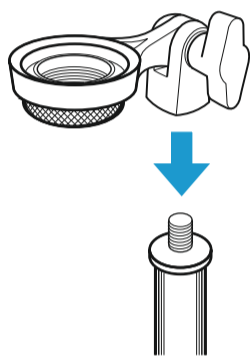

2

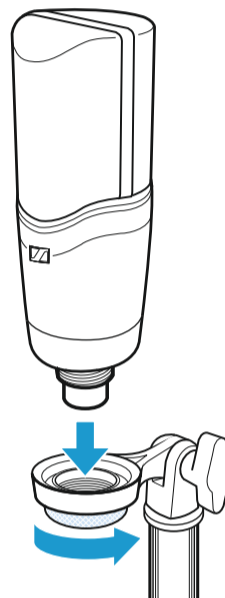

3

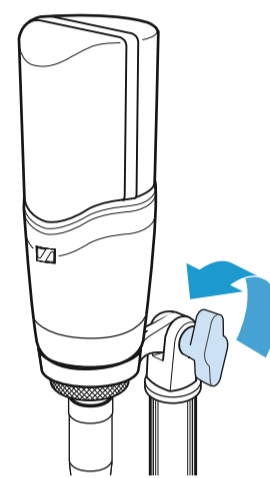

Sennheiser electronic GmbH & Co. KG

Am Labor 1, 30900 Wedemark, Germany
www.sennheiser.com

Printed in Germany, Publ. 12/20, 857474/A01

Adjusting

low-cut/roll-off filter



Hz 0 100 60

- off
- roll-off, -6 dB/oct.
- low-cut, -18 dB/oct.

attenuation



-20 -10 0 dB

- 20 dB reduces by 20 dB
- 10 dB reduces by 10 dB
- 0 dB no attenuation

pick-up pattern

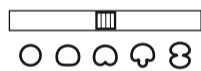

- omni-directional
- wide cardioid
- cardioid
- super-cardioid
- figure-of-eight

Cleaning

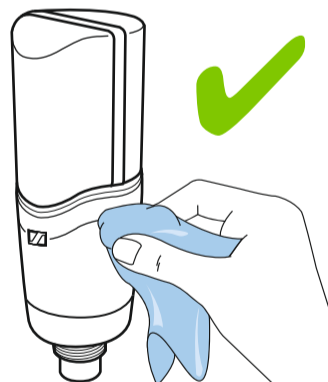

Accessory

1

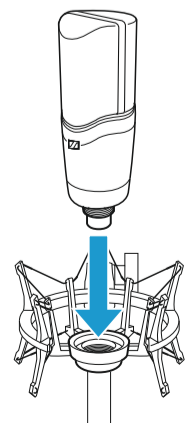

MKS 4*

2

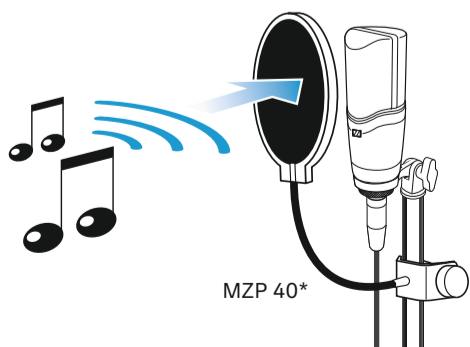
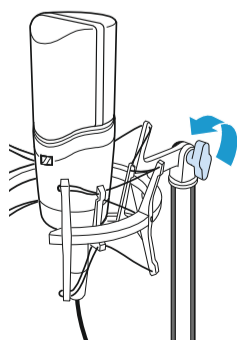

MZP 40*

MKW 4*

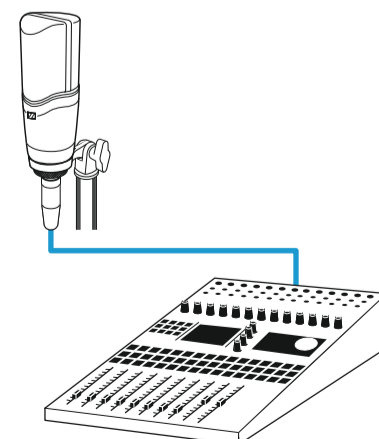
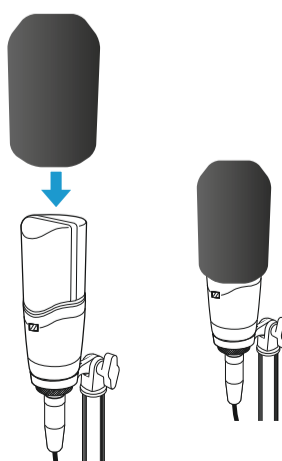

P48 IEC 61938

*optional accessories

Specifications

Transducer principle	externally polarized dual diaphragm condenser microphone
Diameter of diaphragm	25.4 mm / 1"
Acoustic operating principle	pressure gradient transducer
Pick-up pattern, switchable	omni-directional, wide cardioid, cardioid, super-cardioid, figure-of-eight
Frequency response	20 - 20,000 Hz
Sensitivity	14.1 mV/Pa (-37 dBV)
Max. SPL	142 dB (attenuation: 0 dB)
Equivalent noise level	10 dB(A) (IEC 61672-1) 16 dB (CCIR 468-3)
Dynamic range	132 dB
Nominal impedance	50 Ω
Min. terminating impedance	1 kΩ
Phantom powering	48 V ± 4 V (P48, IEC 61938)
Low cut/roll-off filter, switchable	linear
Attenuation, switchable	0 dB, -10 dB, -20 dB
Current consumption	4.1 mA
Temperature range	Operation: 0 °C to +40 °C Storage: -10 °C to +60 °C
Dimension	∅ 57 mm x 160 mm
Weight	485 g

Connector assignment

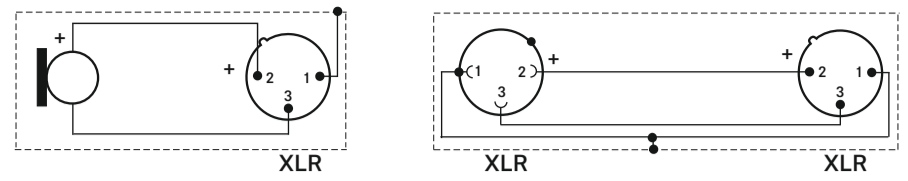

Polar pattern and frequency response

