

Kramer Electronics, Ltd.



USER MANUAL

Model:

SPK-OC608

On-Wall Speakers

Contents

1	Introduction	1
2	Getting Started	1
3	Overview	1
4	Your SPK-OC608	2
5	Installing the Speakers	3
5.1	Choosing the Best Location	3
5.2	Installing the Speaker Wires	3
5.3	Installing the Mounting Bracket	4
5.3.1	Installing the Mounting Bracket onto the Wall	4
6	Technical Specifications	5

Figures

Figure 1:	SPK-OC608	2
Figure 2:	Installing the Fixed Bracket	4

1 Introduction

Welcome to Kramer Electronics! Since 1981, Kramer Electronics has been providing a world of unique, creative, and affordable solutions to the vast range of problems that confront the video, audio, presentation, and broadcasting professional on a daily basis. In recent years, we have redesigned and upgraded most of our line, making the best even better! Our 500-plus different models now appear in eight groups¹ that are clearly defined by function.

Congratulations on purchasing your Kramer **SPK-OC608** *On-Wall Speakers*, which are ideal for:

- Home theater sound systems
- Outdoor areas
- Multimedia systems

The package includes the following items:

- **SPK-OC608** *On-Wall Speakers*
- Mounting brackets
- This user manual²

2 Getting Started

We recommend that you:

- Unpack the equipment carefully and save the original box and packaging materials for possible future shipment
- Review the contents of this user manual
- Use Kramer high performance cables³

3 Overview

The **SPK-OC608** includes a pair of high performance speakers that can be mounted on the wall vertically or horizontally, and indoors as well as outdoors⁴. The mounting brackets are made of hardened steel that can be attached to each speaker, letting you rotate each speaker to the left or right.

1 GROUP 1: Distribution Amplifiers; GROUP 2: Video and Audio Switchers, Matrix Switchers and Controllers; GROUP 3: Video, Audio, VGA/XGA Processors; GROUP 4: Interfaces and Sync Processors; GROUP 5: Twisted Pair Interfaces; GROUP 6: Accessories and Rack Adapters; GROUP 7: Scan Converters and Sealers; and GROUP 8: Cables and Connectors

2 Download up-to-date Kramer user manuals from the Internet at this URL: <http://www.kramerelectronics.com>

3 The complete list of Kramer cables is on our Web site at <http://www.kramerelectronics.com>

4 The speakers are weather resistant but not waterproof, and can withstand the humidity in the air. We recommend that you locate them in an area that is covered and protected from rain

To achieve the best performance:

- Connect only good quality connection cables¹, thus avoiding interference, deterioration in signal quality due to poor matching, and elevated noise- levels (often associated with low quality cables)
- Avoid interference from neighboring electrical appliances and position your Kramer **SPK-OC608** away from moisture, excessive sunlight and dust

4 Your SPK-OC608

Figure 1 and Table 1 define the **SPK-OC608**:

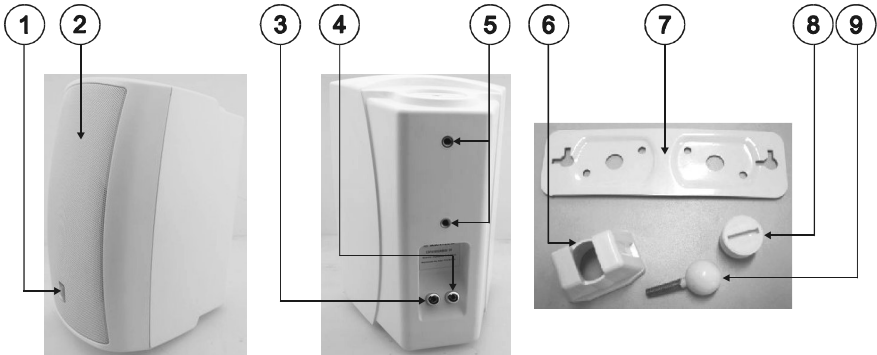

Figure 1: SPK-OC608

Table 1: SPK-OC608 Features (for one of the speakers)

#	Feature	Function	
1	Kramer Logo	Gently pull the spring-loaded logo to set it to the horizontal position if the speakers are mounted horizontally	
2	Speaker Grille	Do not remove from the speakers	
3	Screw Type Input Port	Negative (black)	Connect to the negative stereo analog audio output of the receiver
4		Positive (red)	Connect to the positive stereo analog audio output of the receiver
5	Threaded holes (2)	Used for installing the mounting bracket	
6	Fixture (2)	Used for the mounting bracket	
7	Fixed bracket		
8	ABS screw (2)		
9	Ball (2)		

¹ Such as the Kramer BC-2S cable

5 Installing the Speakers

This section explains how to:

- Choose the best location for your speakers (see section 5.1)
- Install the speaker wires (see section 5.2)
- Install the mounting brackets (see section 5.3)

5.1 Choosing the Best Location

Before installing the speakers:

- Experiment by placing the speakers in different locations before finally deciding on the most suitable location
- Be sure that the wall type is appropriate for the mounting brackets, that is, either solid wood, bricks, concrete, hollow building blocks, or wood studs. You cannot mount the brackets on gypsum walls
- Check that the mounting location is free of obstructions, such as electrical piping, AC ducts or water lines, and so on

5.2 Installing the Speaker Wires

To install the speakers, do the following:

1. Prepare the wires for the speakers:
 - Use two stranded 16-gauge speaker wires¹ of similar length²
 - Measure the length to reach from each speaker to the receiver, adding some access wire length to let you easily remove the speakers from the bracket without having to disconnect the input wires
2. Strip the ends of the wires approximately 3/8 inch.
3. Pass the speaker wires through the round hole in the mounting bracket.
4. Unscrew the negative (black) screw-type connector, insert the wire from the negative terminal on the receiver, and retighten.
5. Unscrew the positive (red) screw-type connector, insert the wire from the positive terminal on the receiver, and retighten.
6. Insert the brackets (see section 5.3)

¹ It is recommended to use the Kramer BC-2S cables

² For achieving high quality sound

5.3 Installing the Mounting Bracket

To install the mounting brackets, as illustrated in Figure 2, do the following:

1. Insert the ballmount into the fixture (see Figure 2A).
2. Insert the ABS screw mount into the fixture over the ball mount (see Figure 2B).
3. Using the bracket, or any metal piece, tighten the ABS screw.
4. Screw the fixture into the two threaded holes on the speaker (see Figure 2C).
5. Place the metal bracket on the two fixtures, insert the four bracket screws and tighten (see Figure 2D).

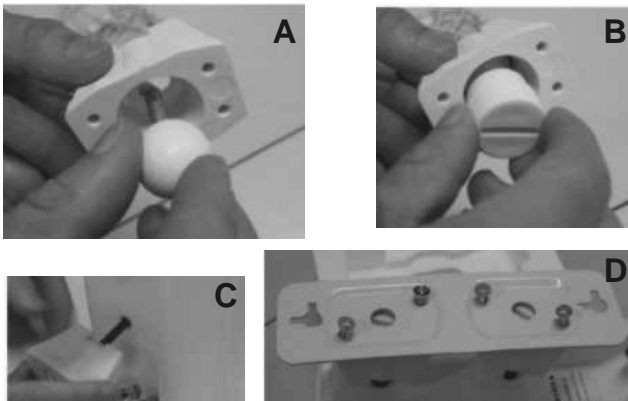

Figure 2: Installing the Fixed Bracket

5.3.1 Installing the Mounting Bracket onto the Wall

To install the bracket onto the wall, do the following:

1. Mark the location of the mounting holes.
2. Screw mounting screws¹ into the mounting holes.
3. Slide the mounting bracket over the mounting screws so that the mounting bracket is secured to the surface.

¹ Not included in the package

6 Technical Specifications¹

Table 2 includes the technical specifications of the **SPK-OC608**:

Table 2: Technical Specifications of the SPK-OC608

FREQUENCY RESPONSE:	30Hz to 20kHz
WOOFER:	6.5" (165mm) rubber surround
TWEETER:	25mm polypropylene
PASSIVE:	27mm piezo dome
CROSSOVER:	With 12dB/octave
SENSITIVITY:	88dB (2.83V @ 1 meter)
FREE AIR RESONANT FREQUENCY:	55Hz
NOMINAL IMPEDANCE:	6Ω to 8Ω
POWER HANDLING ² :	80Watts RMS to 120 Watts (IPP)
DIMENSIONS:	19.3cm x 18.8cm x 25.98cm (7.6" x 7.4" x 10.23"), W, D, H
WEIGHT:	One speaker: 2.6kg (5.7lbs) approx. Shipping weight: (for pair): 5.6kg (12.3lbs) approx.
ACCESSORIES:	Two mounting brackets (fixed and rotating)

¹ Specifications are subject to change without notice

² Power handling is based on the amplifier volume never being set above the point of audible distortion

LIMITED WARRANTY

Kramer Electronics (hereafter *Kramer*) warrants this product free from defects in material and workmanship under the following terms.

HOW LONG IS THE WARRANTY

Labor and parts are warranted for one year from the date of the first customer purchase.

WHO IS PROTECTED?

Only the first purchase customer may enforce this warranty.

WHAT IS COVERED AND WHAT IS NOT COVERED

Except as below, this warranty covers all defects in material or workmanship in this product. The following are not covered by the warranty:

1. Any product which is not distributed by Kramer, or which is not purchased from an authorized Kramer dealer. If you are uncertain as to whether a dealer is authorized, please contact Kramer at one of the agents listed in the Web site www.kramerelectronics.com.
2. Any product, on which the serial number has been defaced, modified or removed.
3. Damage, deterioration or malfunction resulting from:
 - i) Accident, misuse, abuse, neglect, fire, water, lightning or other acts of nature
 - ii) Product modification, or failure to follow instructions supplied with the product
 - iii) Repair or attempted repair by anyone not authorized by Kramer
 - iv) Any shipment of the product (claims must be presented to the carrier)
 - v) Removal or installation of the product
 - vi) Any other cause, which does not relate to a product defect
 - vii) Cartons, equipment enclosures, cables or accessories used in conjunction with the product

WHAT WE WILL PAY FOR AND WHAT WE WILL NOT PAY FOR

We will pay labor and material expenses for covered items. We will not pay for the following:

1. Removal or installations charges.
2. Costs of initial technical adjustments (set-up), including adjustment of user controls or programming. These costs are the responsibility of the Kramer dealer from whom the product was purchased.
3. Shipping charges.

HOW YOU CAN GET WARRANTY SERVICE

1. To obtain service on you product, you must take or ship it prepaid to any authorized Kramer service center.
2. Whenever warranty service is required, the original dated invoice (or a copy) must be presented as proof of warranty coverage, and should be included in any shipment of the product. Please also include in any mailing a contact name, company, address, and a description of the problem(s).
3. For the name of the nearest Kramer authorized service center, consult your authorized dealer.

LIMITATION OF IMPLIED WARRANTIES

All implied warranties, including warranties of merchantability and fitness for a particular purpose, are limited in duration to the length of this warranty.

EXCLUSION OF DAMAGES

The liability of Kramer for any effective products is limited to the repair or replacement of the product at our option. Kramer shall not be liable for:

1. Damage to other property caused by defects in this product, damages based upon inconvenience, loss of use of the product, loss of time, commercial loss; or:
2. Any other damages, whether incidental, consequential or otherwise. Some countries may not allow limitations on how long an implied warranty lasts and/or do not allow the exclusion or limitation of incidental or consequential damages, so the above limitations and exclusions may not apply to you.

This warranty gives you specific legal rights, and you may also have other rights, which vary from place to place.

NOTE: All products returned to Kramer for service must have prior approval. This may be obtained from your dealer.

This equipment has been tested to determine compliance with the requirements of:

- EN-50081: "Electromagnetic compatibility (EMC);
generic emission standard.
Part 1: Residential, commercial and light industry"
- EN-50082: "Electromagnetic compatibility (EMC) generic immunity standard.
Part 1: Residential, commercial and light industry environment".
- CFR-47: FCC Rules and Regulations:
Part 15: "Radio frequency devices
Subpart B Unintentional radiators"

CAUTION!

Servicing the machines can only be done by an authorized Kramer technician. Any user who makes changes or modifications to the unit without the expressed approval of the manufacturer will void user authority to operate the equipment.

Use the supplied DC power supply to feed power to the machine.

Please use recommended interconnection cables to connect the machine to other components.



For the latest information on our products and a list of Kramer distributors, visit our Web site: www.kramerelectronics.com, where updates to this user manual may be found. We welcome your questions, comments and feedback.



Kramer Electronics, Ltd.

Web site: www.kramerelectronics.com

E-mail: info@kramerelect.com

P/N: 2900-000470 REV 1