

Kramer Electronics, Ltd.



USER MANUAL

Wall Plate Series

WAP-1

Contents

1	Introduction	1
2	Getting Started	1
3	Overview	1
4	Your WAP-1 Audio Wall Plate	2
4.1	The WAP-1 European Version	2
4.1.1	Mounting the WAP-1 (European Version)	4
4.2	The WAP-1 US Version	5
4.2.1	Mounting the WAP-1 (US Version)	6
5	Technical Specifications	6

Figures

Figure 1:	WAP-1 (European Version)	2
Figure 2:	WAP-1 Internal Frame (European Version)	3
Figure 3:	Mounting the WAP-1 (European Version)	4
Figure 4:	WAP-1 (US Version)	5

Tables

Table 1:	WAP-1 Features	3
Table 2:	WAP-1 Internal Frame Features	3
Table 3:	WAP-1 Features (US Version)	5
Table 4:	Technical Specifications of the WAP-1	6

1 Introduction

Welcome to Kramer Electronics (since 1981): a world of unique, creative and affordable solutions to the infinite range of problems that confront the video, audio and presentation professional on a daily basis. In recent years, we have redesigned and upgraded most of our line, making the best even better! Our 500-plus different models now appear in 8 Groups¹, which are clearly defined by function.

Congratulations on purchasing your Kramer **WAP-1** wall plate², which is ideal for the following applications: board, conference and training rooms, presentation systems, and long distance signal distribution and home theater.

The package includes the following items:

- **WAP-1** with a frame connected to the front panel
- Four self-tapping screws for fastening the frame to the wall
- This user manual³

2 Getting Started

We recommend that you:

- Unpack the equipment carefully and save the original box and packaging materials for possible future shipment
- Review the contents of this user manual
- Use Kramer high performance high resolution cables⁴

3 Overview

The Kramer **WAP-1** is a wall plate with two unbalanced stereo audio inputs (INPUT 1 and INPUT 2) on 3.5mm mini jack connectors on the front panel (INPUT 1 can also be accessed via an unbalanced stereo audio 3-pole terminal block connector on the rear panel). The stereo audio (SPKR OUT) output on a 4-pole terminal block connector is located on the rear panel. The **WAP-1** has audio level control which is used to adjust the signal level.

1 GROUP 1: Distribution Amplifiers; GROUP 2: Video and Audio Switchers, Matrix Switchers and Controllers; GROUP 3: Video, Audio, VGA/XGA Processors; GROUP 4: Interfaces and Sync Processors; GROUP 5: Twisted Pair Interfaces; GROUP 6: Accessories and Rack Adapters; GROUP 7: Scan Converters and Sealers; and GROUP 8: Cables and Connectors

2 Each wall plate is supplied with the required M3x4 screws

3 Download up-to-date Kramer user manuals from our Web site at <http://www.kramerelectronics.com>

4 The complete list of Kramer cables is on our Web site at <http://www.kramerelectronics.com>

To achieve the best performance you should:

- Connect only good quality connection cables, thus avoiding interference, deterioration in signal quality, and elevated noise levels (often associated with low quality cables)
- Position your Kramer wall plate securely, and in a location that is free from moisture and away from excessive sunlight and dust

4 Your WAP-1 Audio Wall Plate

The **WAP-1** is available in two versions:

- The European version¹, including England, Belgium and the rest of Europe (see section 4.1)
- The US version (see section 4.2)

4.1 The WAP-1 European Version

Figure 1, Figure 2, Table 1 and Table 2 define the **WAP-1** European version:

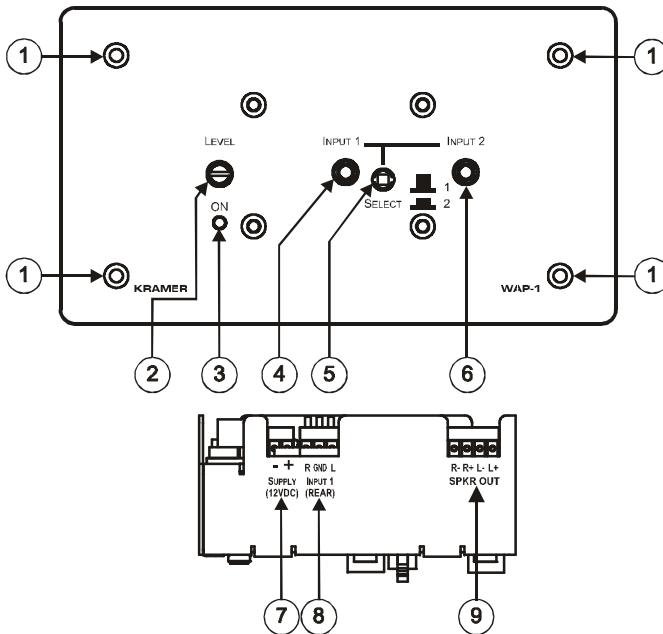

Figure 1: WAP-1 (European Version)

¹ Previously there was a version for England and Europe, and a separate version for Belgium

Your WAP-1 Audio Wall Plate

Table 1: WAP-1 Features

#	Feature	Function
1	Panel Screw Holes	Fasten the panel to the internal frame via the four panel screws
2	LEVEL Potentiometer	Adjusts ¹ the stereo audio output signal level
3	ON LED	Illuminates when receiving power
4	INPUT 1 Unbalanced Stereo AUDIO 3.5mm Mini Jack	Connects ² to the unbalanced stereo audio source 1
5	SELECT Button	Press to select input 2, or release to select input 1
6	INPUT 2 Unbalanced Stereo AUDIO 3.5mm Mini Jack	Connects to the unbalanced stereo audio source 2
7	SUPPLY (12VDC) / POWER ³	Connect "-" to the Ground; "+" to the connector for powering the unit
8	INPUT 1 (REAR) Unbalanced Stereo AUDIO Terminal Block connector	Connects ² to the unbalanced stereo audio source 1 (via 3 rear panel PINS)
9	SPKR OUT Terminal Block Connector	Connects to the stereo audio speakers

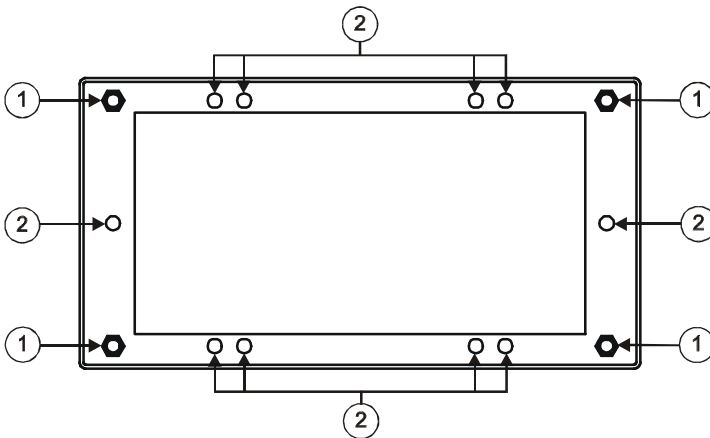

Figure 2: WAP-1 Internal Frame (European Version)

Table 2: WAP-1 Internal Frame Features

#	Feature	Function
1	Panel Screw Holes	For connecting the panel to the frame
2	Frame Screw Holes	For connecting the frame to the wall using the self-tapping screws (provided). Use the holes according to your local standard (two or four screws)

1 Use a screwdriver to carefully rotate the Potentiometer, adjusting the appropriate level

2 Alternative ways to connect to source 1

3 Connect your 12V DC power supply to these PINS, taking care that the polarity is correct: the wire labeled "+" to the +12V pin, and the wire labeled "-" to the GND pin

4.1.1 Mounting the WAP-1 (European Version)

Figure 3 illustrates how to mount the Wall Plate:

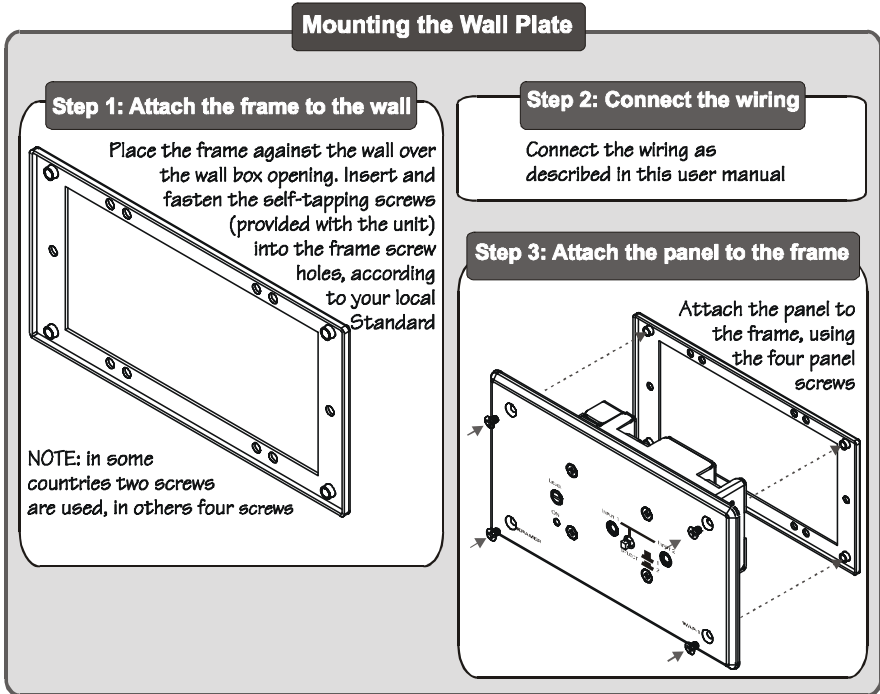

Figure 3: Mounting the WAP-1 (European Version)

4.2 The WAP-1 US Version

Figure 4 and Table 3 define the **WAP-1** US version:

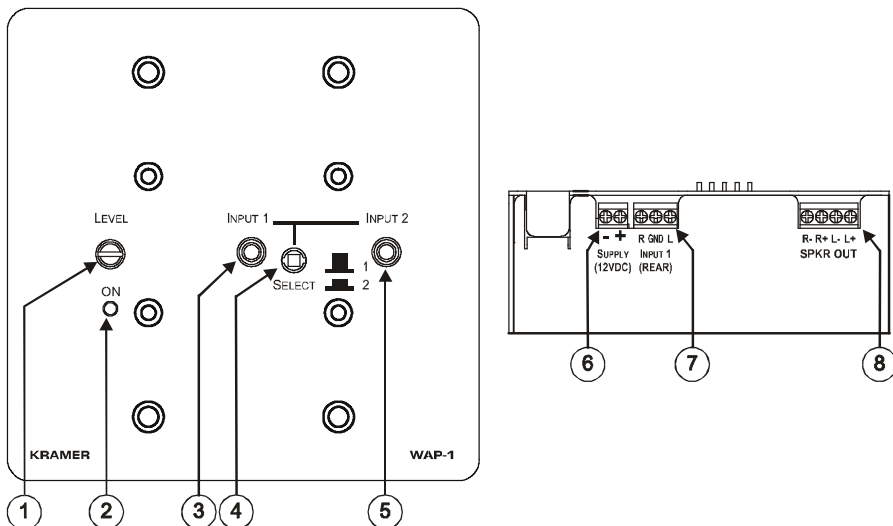

Figure 4: WAP-1 (US Version)

Table 3: WAP-1 Features (US Version)

#	Feature	Function
1	LEVEL Potentiometer	Adjusts ¹ the stereo audio output signal level
2	ON LED	Illuminates when receiving power
3	INPUT 1 Unbalanced Stereo AUDIO 3.5mm Mini Jack	Connects ² to the unbalanced stereo audio source 1
4	SELECT Button	Press to select input 2, or release to select input 1
5	INPUT 2 Unbalanced Stereo AUDIO 3.5mm Mini Jack	Connects to the unbalanced stereo audio source 2
6	SUPPLY (12VDC) / POWER ³	Connect “-” to the Ground; “+” to the connector for powering the unit
7	INPUT 1 (REAR) Unbalanced Stereo AUDIO Terminal Block connector	Connects ² to the unbalanced stereo audio source 1 (via 3 rear panel PINS)
8	SPKR OUT Terminal Block Connector	Connects to the stereo audio speakers

1 Use a screwdriver to carefully rotate the Potentiometer, adjusting the appropriate level

2 Alternative ways to connect to source 1

3 Connect your 12V DC power supply to these PINS, taking care that the polarity is correct: the wire labeled “+” to the +12V pin, and the wire labeled “-” to the GND pin

4.2.1 Mounting the WAP-1 (US Version)

To mount the **WAP-1**:

- Place the wall plate against the wall over the wall box opening
- Insert and fasten the four screws provided with the unit

5 Technical Specifications

Table 4 includes the technical specifications:

Table 4: Technical Specifications¹ of the WAP-1

INPUTS:	2 stereo inputs on 3.5mm Mini Jacks, input 1 also on a 3-PIN Terminal Block
OUTPUTS:	1 Stereo Output for speakers
OUTPUT POWER:	9W RMS continuous per channel
BANDWIDTH (-3dB):	50kHz
S/N RATIO:	70dB
CROSSTALK (all hostile):	<-69dB@1kHz
CONTROLS:	Level: <-17dB to 26dB; Input Selector Switch
COUPLING:	Input: AC; Output: DC
AUDIO THD + NOISE:	0.7%
AUDIO 2nd HARMONIC:	0.58%
POWER SOURCE:	12 VDC, 2.3A (27.6Watt)
DIMENSIONS:	Europe: 15.1cm x 8.6cm x 4cm (5.95" x 3.39" x 1.6"), W, D, H USA: 11.4cm x 8cm x 11.4cm (4.5" x 3.2" x 4.5"), W, D, H
WEIGHT:	0.3 kg (0.67 lbs.) approx
ACCESSORIES:	Power supply

¹ Specifications are subject to change without notice

LIMITED WARRANTY

Kramer Electronics (hereafter *Kramer*) warrants this product free from defects in material and workmanship under the following terms.

HOW LONG IS THE WARRANTY

Labor and parts are warranted for seven years from the date of the first customer purchase.

WHO IS PROTECTED?

Only the first purchase customer may enforce this warranty.

WHAT IS COVERED AND WHAT IS NOT COVERED

Except as below, this warranty covers all defects in material or workmanship in this product. The following are not covered by the warranty:

1. Any product which is not distributed by Kramer, or which is not purchased from an authorized Kramer dealer. If you are uncertain as to whether a dealer is authorized, please contact Kramer at one of the agents listed in the web site www.kramerelectronics.com.
2. Any product, on which the serial number has been defaced, modified or removed.
3. Damage, deterioration or malfunction resulting from:
 - i) Accident, misuse, abuse, neglect, fire, water, lightning or other acts of nature
 - ii) Product modification, or failure to follow instructions supplied with the product
 - iii) Repair or attempted repair by anyone not authorized by Kramer
 - iv) Any shipment of the product (claims must be presented to the carrier)
 - v) Removal or installation of the product
 - vi) Any other cause, which does not relate to a product defect
 - vii) Cartons, equipment enclosures, cables or accessories used in conjunction with the product

WHAT WE WILL PAY FOR AND WHAT WE WILL NOT PAY FOR

We will pay labor and material expenses for covered items. We will not pay for the following:

1. Removal or installations charges.
2. Costs of initial technical adjustments (set-up), including adjustment of user controls or programming. These costs are the responsibility of the Kramer dealer from whom the product was purchased.
3. Shipping charges.

HOW YOU CAN GET WARRANTY SERVICE

1. To obtain service on you product, you must take or ship it prepaid to any authorized Kramer service center.
2. Whenever warranty service is required, the original dated invoice (or a copy) must be presented as proof of warranty coverage, and should be included in any shipment of the product. Please also include in any mailing a contact name, company, address, and a description of the problem(s).
3. For the name of the nearest Kramer authorized service center, consult your authorized dealer.

LIMITATION OF IMPLIED WARRANTIES

All implied warranties, including warranties of merchantability and fitness for a particular purpose, are limited in duration to the length of this warranty.

EXCLUSION OF DAMAGES

The liability of Kramer for any effective products is limited to the repair or replacement of the product at our option. Kramer shall not be liable for:

1. Damage to other property caused by defects in this product, damages based upon inconvenience, loss of use of the product, loss of time, commercial loss; or
2. Any other damages, whether incidental, consequential or otherwise. Some countries may not allow limitations on how long an implied warranty lasts and/or do not allow the exclusion or limitation of incidental or consequential damages, so the above limitations and exclusions may not apply to you.

This warranty gives you specific legal rights, and you may also have other rights, which vary from place to place.

NOTE: All products returned to Kramer for service must have prior approval. This may be obtained from your dealer.

This equipment has been tested to determine compliance with the requirements of:

- EN-50081: "Electromagnetic compatibility (EMC);
generic emission standard.
Part 1: Residential, commercial and light industry"
- EN-50082: "Electromagnetic compatibility (EMC) generic immunity standard.
Part 1: Residential, commercial and light industry environment".
- CFR-47:
FCC Rules and Regulations:
Part 15: "Radio frequency devices
Subpart B – Unintentional radiators"

CAUTION!

- ☒ Servicing the machines can only be done by an authorized Kramer technician. Any user who makes changes or modifications to the unit without the expressed approval of the manufacturer will void user authority to operate the equipment.
- ☒ Use the supplied DC power supply to feed power to the machine.
- ☒ Please use recommended interconnection cables to connect the machine to other components.





For the latest information on our products and a list of Kramer distributors, visit our Web site: www.kramerelectronics.com, where updates to this user manual may be found. We welcome your questions, comments and feedback.



Caution

Safety Warning:

Disconnect the unit from the power supply before opening/servicing.



Kramer Electronics, Ltd.

Web site: www.kramerelectronics.com

E-mail: info@kramerel.com

P/N: 2900-000065 REV 2