

The Kramer MTH-3 VESA Adapter Bracket

Congratulations on purchasing your Kramer **MTH-3 VESA Adapter Bracket** for mounting Kramer TOOLS™, Pico TOOLS® and MegaTOOLS® on the rear panel of large displays.

The **MTH-3 VESA Adapter Bracket** kit includes:

- **MTH-3 VESA Adapter Bracket**
- Two spacers

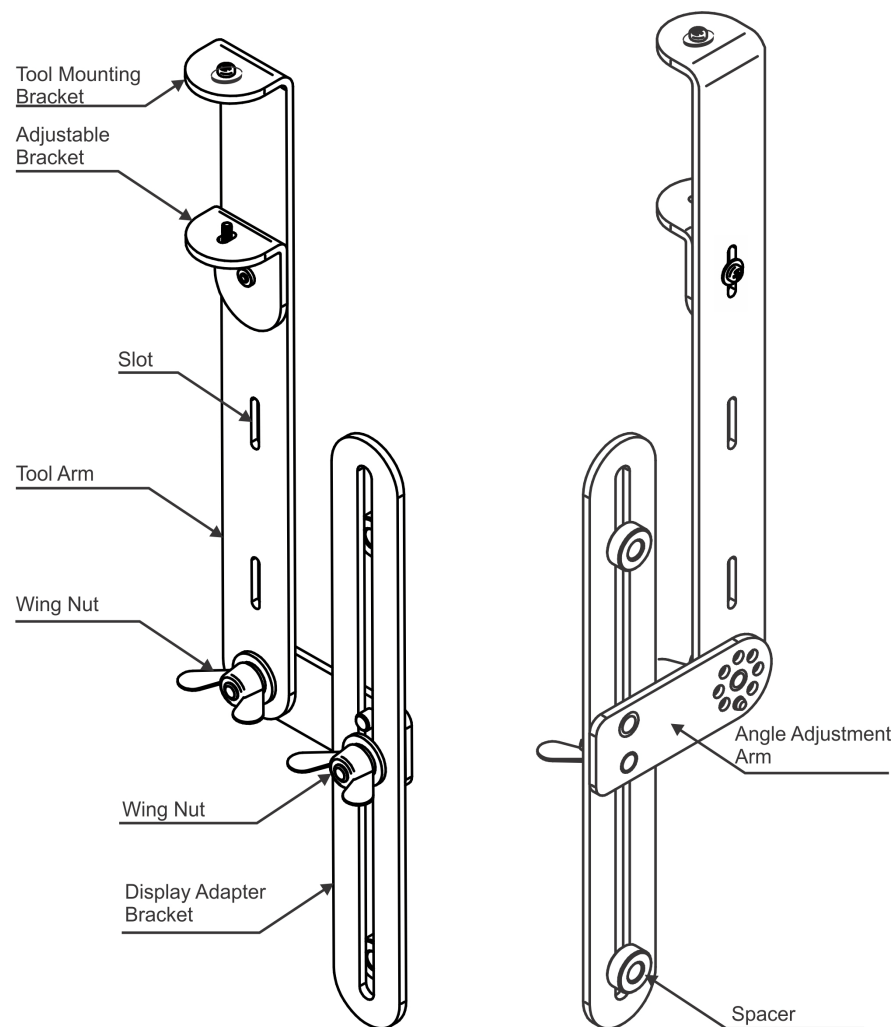

Figure 1: MTH-3 VESA Adapter Bracket

Installation

To mount a tool on the **MTH-3 VESA Adapter Bracket**, do the following:

1. Remove the two M3x6 from the sides of the tool to be mounted.
2. Remove the two M3x8 screws (supplied with the **MTH-3**) from the Tool Brackets to use in the following steps.
3. Place the tool (for example, a Pico TOOLS®) on the Tool Arm and attach the Tool Mounting Bracket to the side of the TOOL with the M3x8 screw (Figure 2 **A**).
4. Attach the Adjustable Bracket to the other side of the TOOL with the second M3x8 screw (Figure 2 **B**).
5. Use the third M3x8 screw to fix the adjustable bracket to the appropriate slot (for Pico TOOLS®, TOOLS™ or MegaTOOLS®, respectively) (Figure 2 **B**).

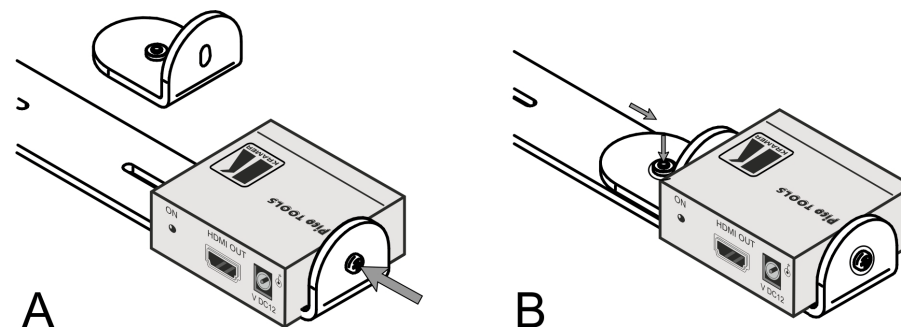

Figure 2: Installing a Pico TOOL

6. Slightly loosen the wing nuts to set the position of the **MTH-3** to the desired angle and then retighten the wing nuts.
Set the angle by inserting the pin on the Tool Arm into one of the holes in the Angle Adjustment Arm
7. Place the TOOL with the brackets over the rear side of the display, and position the display mounting wing over two of VESA standard holes on the rear side of the display.
8. Place the two spacers between the Display Adapter Bracket and the display.
9. Place a spring washer (if supplied by the display manufacturer) over each of the two screws (supplied by the display manufacturer).
10. Tighten the two screws to attach the **MTH-3** to the rear side of the display.

The location of the screw-holes, as well as the number of screws used for each display may vary, depending on the manufacturer



Note that both wing nuts can be loosened so that the position and angle of the arms can be readjusted, and then retightened at the new position.



KRAMER ELECTRONICS LTD.

Installation Instructions

MODEL:

MTH-3
VESA Adapter Bracket

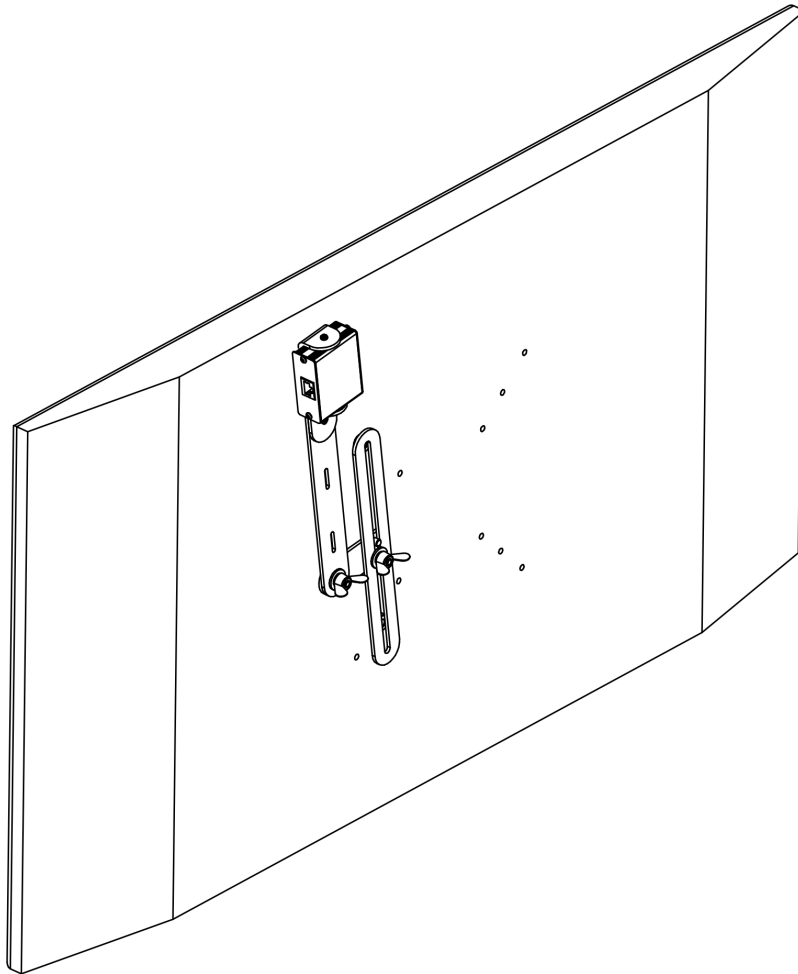

Figure 3: The MTH-3 Attached to the Rear Side of the Display



Note that the **MTH-3** is attached to the rear side of the display using the screws that were supplied with the display (either screwed into its rear side or in a separate bag).

For the latest information on our products and a list of Kramer distributors, visit our Web site where updates to this user manual/Installation instructions may be found.

We welcome your questions, comments, and feedback.

Web site: www.kramerelectronics.com

E-mail: info@kramerelect.com



SAFETY WARNING

Disconnect the unit from the power supply before opening and servicing

P/N: 2900-3001 10 Rev 1