

The VC215 is an 90° angled male to female RCA/Cinch adapter for connecting a cable to a device that is placed in a small environment or to reduce the strain on the cable when it is built in to a wall or laid in a cable gutter. The durable metal housing offers an overall RF protection and electromagnetic shielding.

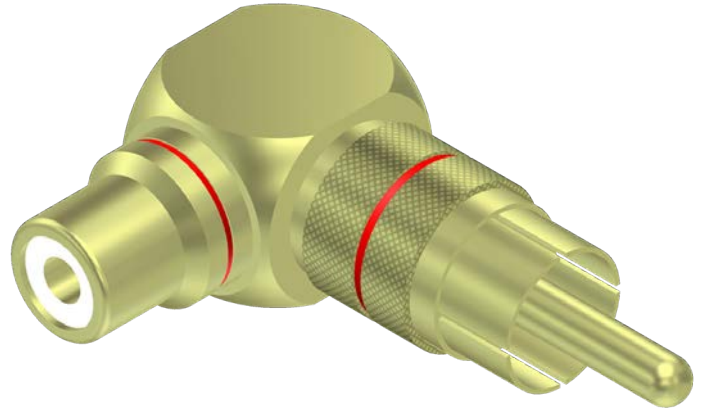

#### Properties:

---



#### Usage:

---



#### Variants:

---

- VC215 - Adapter
- VC215-P - Adapter 25 pcs box